

## Overview - St Asaph Street, Ferry Road to Antigua Street.

19/05/2016

Christchurch City Council has contracted Fulton Hogan to construct the separated cycleway and other streetworks on St Asaph Street.

The one-way road carrying westbound traffic will be a key cycle route south of the Central City.

Approved by the City Council in December 2015, the project was signalled in An Accessible City, the transport chapter of the Christchurch Central Recovery Plan. For more information about An Accessible City visit

[www.ccc.govt.nz/AACtransportprojects](http://www.ccc.govt.nz/AACtransportprojects)

**What:** Work will include the construction of a separate cycleway on the south side of the street, sections of kerb and footpaths will be replaced, landscaping and sections of road will be resurfaced.

**When:** Wednesday 25 May until the end of 2016. All work will begin with traffic management set up and service investigations in the designated areas of work, see map below.

### This work will be carried out over three areas.

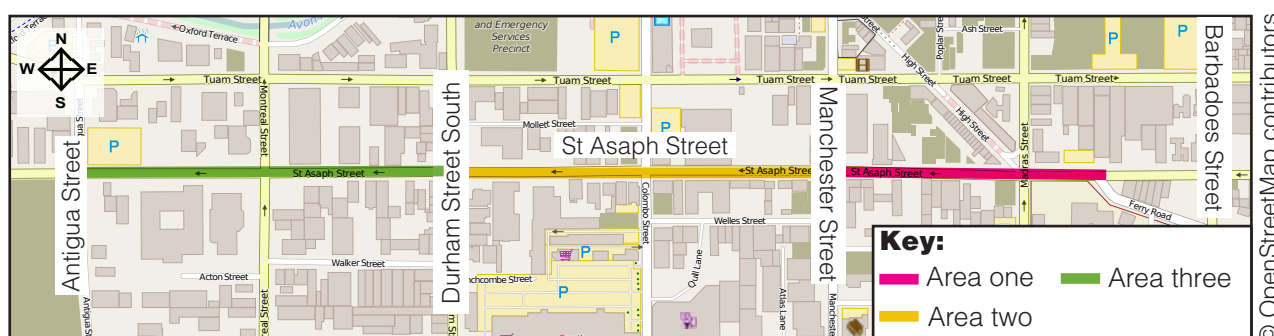

### Area one: St Asaph Street, between Ferry Road and Manchester Street.

Area one will begin Wednesday 25 May.

#### Traffic changes:

- There will be no right turn from Madras Street to St Asaph Street or St Asaph Street to Ferry Road, this will be a permanent change.
- The area around the High Street intersection will be fenced off, there will be no parking on High Street from Wednesday 25 May.
- We will aim to keep two lanes of traffic throughout the project, please be on the lookout for changes in traffic management and electronic notice boards advertising upcoming changes.

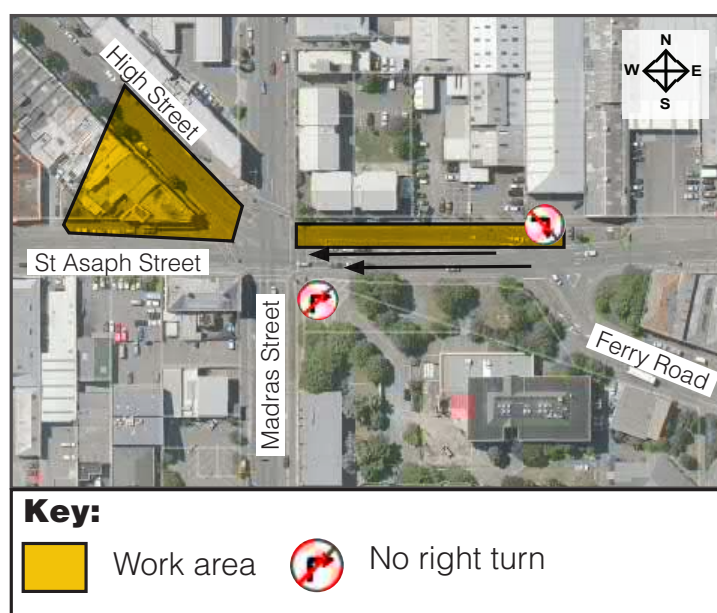

## Area two: St Asaph Street, between Manchester Street and Durham Street South, and area three: St Asaph Street, between Durham Street South, and Antigua Street.

Work in area two and three will begin Wednesday 25 May with service investigation work, a small area will be coned off during this work. Following this we will begin work on the cycleway on the south side of the street, sections of kerb and footpaths will be replaced, landscaping and sections of road will be resurfaced. We will update you as this work progresses.

### Traffic changes:

- We will aim to keep two lanes of traffic throughout the project, please be on the lookout for changes in traffic management and electronic notice boards advertising upcoming changes.
- We will work on one side of the road at any one time. When parking or the footpath is unavailable on one side of the street the other side of the street will still accommodate parking and pedestrian walking.

### What to expect:



An example of similar work that has been completed on Tuam Street.

### Benefits of this project:



An enhanced cycle network - connecting with other cycle routes including the Major Cycle Routes.



An enhanced environment - including new islands, more trees and improved lighting.



An enhanced one-way street network - St Asaph Street continues as a key east-to-west one-way corridor.

### Need for information?

**Phone:** 0800 ROAD FH (0800 7623 34)  
(8:30am - 5:00pm Monday - Friday)

**Email:** [rebuildinfo@fultonhogan.com](mailto:rebuildinfo@fultonhogan.com)

**Website:** [www.ccc.govt.nz/AACtransportprojects](http://www.ccc.govt.nz/AACtransportprojects)

**Fulton Hogan**

**0800 ROAD FH**  
(8:30am - 5:00pm Monday - Friday)