

## Appendix Q

### Antonio Hall - Floor plan indicating stages and dates of construction

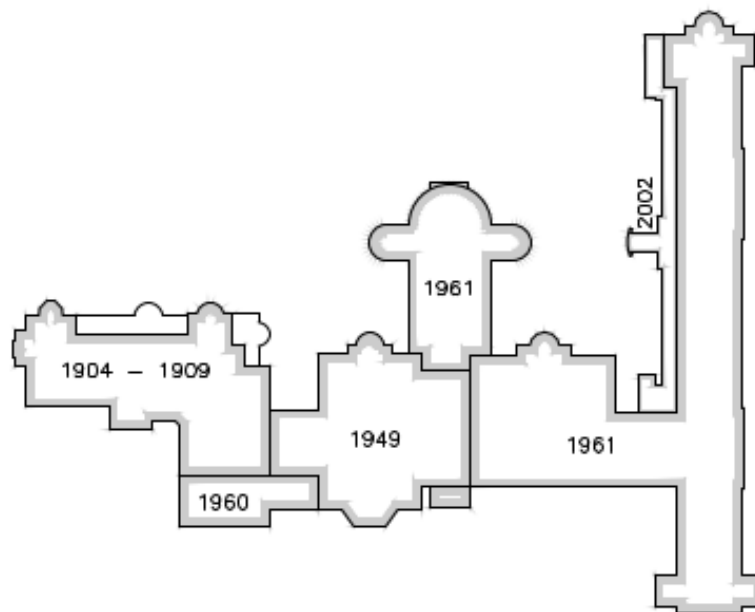

Source: Lewis & Barrow Ltd - Strengthening Options for buildings at 265 Riccarton Road, 26 January 2013. File 21303. Prepared for WellstarCo. Limited.

### Aerial photograph showing extent of fire damage to Middle section and east Wing including chapel, linking block and accommodation wing.



Source - Letter dated 22 December 2021, Miyamoto to Murray Withers, 265 Riccarton Road – Antonio Hall building – Post-fire structural inspection. Project Number 210611

**Aerial photograph showing extent of fire damage to original homestead**



Source - FENZ Memo, Fire Hazard 265 Riccarton Road, 8 November 2021 From Bruce Irvine, Senior Advisor Risk Reduction to Shane Bruyns, Christchurch City Council and Murray Withers (Wellstar Company Ltd) Owners representative.



**Photographs of damaged chapel - 2019**



Source: Council Property Files - 5 August 2019

**Photographs of damaged chapel - 2021**



Source: Council Property files - Brendan Smyth, 2021





Fire damage to accommodation wing roof and gable ends. CCC drone footage, March 2024.







Fire damaged chapel. CCC drone footage, March 2024.