

Nor'west Arc Cycleway – Section Three

Construction of the Nor'west Arc cycleway between Princess Margaret Hospital and the University of Canterbury is nearing completion. This final section will connect the University of Canterbury to the Aorangi Road intersection. This section has received \$10.5million in Government funding. However, if the Option A scenarios below are both selected, they are likely to require an additional \$1million of Council funding.

We're seeking public feedback on the cycleway including the following options:

Option A Ilam Road – one-way cycleway

This option includes one-way cycleways on each side of the road and is considered safer and more intuitive for all users as cyclists are travelling in the same direction as drivers.

Option B Ilam Road – two-way cycleway

This option includes a two way cycleway on the western side of Ilam Road and allows for more on-street parking. However, people turning across the cycleway will need to look for cyclists coming from either direction.

Option A Aorangi Road (Ilam Road to Brookside Terrace) – two-way cycleway

This option includes a two-way cycleway on the west side of Aorangi Road and separates people biking from people walking but removes most on-street parking on Aorangi Road.

Option B Aorangi Road (Ilam Road to Brookside Terrace) – two-way shared path

This option includes a shared path for cyclists and pedestrians on the west side of Aorangi Road. This keeps on-road parking on Aorangi Road but we'll need to remove the silver birch trees along this stretch of road and people walking and biking would share this space.

Kōrero mai | Have your say

1

University to
157 Ilam Road

Te Ara O-Rakipaoa Nor'west Arc Cycleway

University–Jellie Park–Papanui

We want to hear your feedback on the options.
Help us make it way safer for everyone.

ccc.govt.nz/haveyoursay

Consultation closes
Tuesday 12 October 2021

ccc.govt.nz/haveyoursay

Detailed plans, including parking options, are available online to provide easy access to the shops

In areas close to schools and shops we are proposing time restricted parking,

- Option B (shared path) - 129 car parks removed (30%)
- Option A (two-way cycleway) - 199 car parks removed (46%)
- Option B (two-way cycleway) - 123 car parks removed (46%)
- Option A (one-way cycleway) - 143 car parks removed (54%)

Ilam Road

One-way cycleways (Option A) are considered safer and more intuitive for all users. However, a two-way cycleway on Ilam Road (Option B) will keep more parking. On Aorangi Road, the shared path design (Option B) keeps more parking but removes some trees, which will be replaced further north on Aorangi Road.

We know parking is important to residents and businesses, so we've tried to remove as little on-street parking as possible. However both proposed options have some level of parking loss, as the roads aren't wide enough to accommodate the cycleway without this.

Parking options

undertaken prior to the cycleway work beginning.

Additional silver birch trees along Aorangi Road may need to be removed to protect the power lines. This is not part of the cycleway project and may be location.

For each tree removed, two new ones will be planted in the nearest suitable Aorangi Road.

A number of mature trees, predominantly silver birch, will need to be removed to make room for the new cycleway. Up to 20 trees will need to be removed along the route, increasing to 39 if the shared path (option B) is chosen for

Tree removal and replacement

Drop in sessions*

Come and talk to the team about the proposed cycleway

New Generation Church, 309 Clyde Road (corner Aorangi Road)
Monday 20 September, 4.30pm – 6pm

Cobham Intermediate School, 294 Ilam Road
Thursday 23 September, 3pm – 5.30pm

*These sessions may need to be postponed or cancelled if COVID alert levels change. Under current guidelines, 50 people will be allowed inside the venue at one time and attendees will need to stay 2 metres apart. Please scan/sign-in and wear a mask.

Can't make these meetings?

If there is a community meeting you would like us to attend, please let us know. You can also phone any time to speak with us directly about the project.

Senior Engagement Advisor, Tessa Zant

☎ 03 941 8935

✉ tessa.zant@ccc.govt.nz

If you don't have access to a computer, you can get a copy of the plans from Papanui, Riccarton and Fendalton Service Centres, Jellie Park Sports and Recreation Centre and Civic Offices.

ccc.govt.nz/haveyoursay

How to give us your feedback

You can provide your feedback until **12 October 2021** in a number of ways. Let us know your preferred options and please remember to include your full name and address (see note below).

✉ Fill out our online form at ccc.govt.nz/haveyoursay

✉ Email: cycleways@ccc.govt.nz with 'Nor'west Arc' in the subject line.

✉ Mail for free to:
Freepost 178
Attention: Tessa Zant
Public Information & Participation Unit
Christchurch City Council
PO Box 73016, Christchurch 8154

📍 Deliver to: Te Hononga Civic Offices, 53 Hereford Street, or at drop-in sessions.

Please note:

We require your contact details as part of your feedback – it also means we can keep you updated throughout the project. Your feedback, name and address are given to decision-makers (Council) to help them make their decision. Feedback, with names only, go online when the decision meeting agenda is available on our website.

If requested, feedback, names and contact details are made available to the public, as required by the Local Government Official Information and Meetings Act 1987.

If there are good reasons why your details and/or feedback should be kept confidential, please contact our Engagement Manager on (03) 941 8999 or 0800 800 169 (Banks Peninsula).

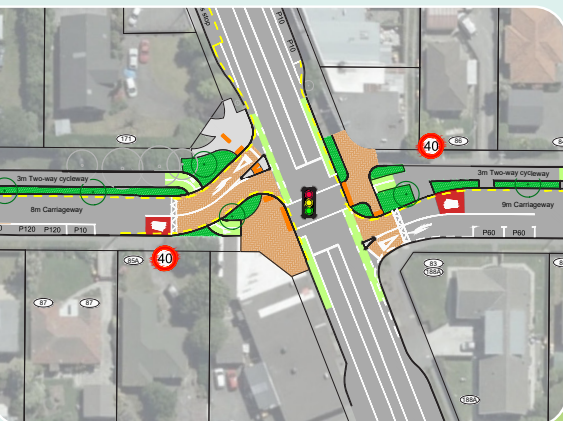

Proposed Wairakei Road intersection layout

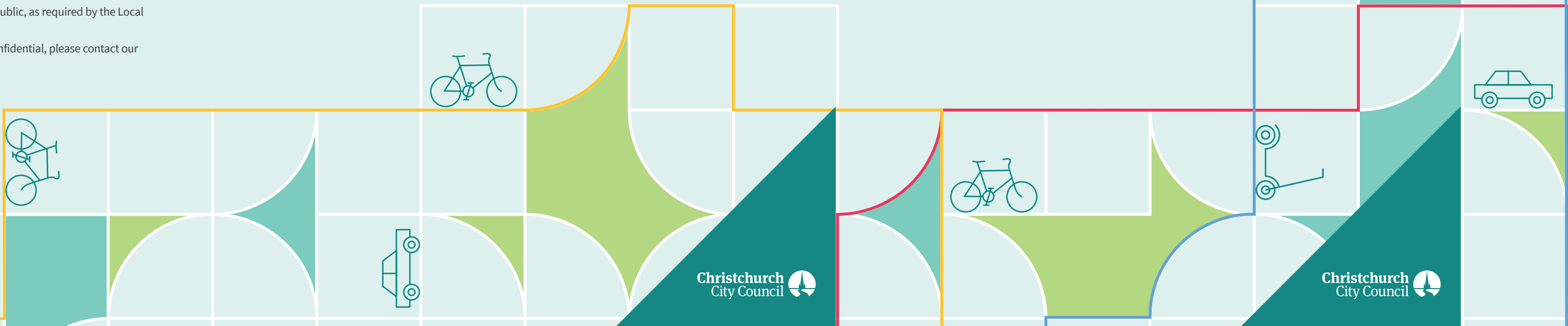

Christchurch
City Council

Christchurch
City Council

Why we're building a cycleway

We're making it safer to bike, walk and drive with our new cycleway. Separating bikes from cars means there's more space for drivers and cyclists, making it safer for everyone on the road.

Cycleways are a key part of our plan to reduce carbon emissions. They also reduce congestion, improve the health of a city, reduce the long-term costs of infrastructure and build stronger local economies.

Te Ara O-Rakipaoa – Nor'west Arc Cycleway is one of 13 Major Cycleways linking schools, businesses, shopping centres, parks and popular recreation destinations all across Christchurch.

The Major Cycleways are different to other cycle lanes around the city. They are designed to encourage people to ride because they can see it's a safe, convenient option to get where they want to go.

The cycleways we have built so far have been well used and helped increase cycling city-wide. A morning count of people biking into the central city showed that 20 per cent more people were biking in March 2020 than a year earlier. This follows a pattern of yearly increases since we began building the cycleways in 2016.

Way safer for everyone

Proposed road layouts along the route will change to improve safety for everyone.

Signalised crossings on Ilam Road between Jellie Park and Burnside / Cobham Schools and across Wairakei Road at the Aorangi intersection will provide safe crossings for both cyclists and pedestrians.

We're proposing to stop through-traffic and right turns for cars on Aorangi Road, at the Wairakei Road intersection. This busy intersection has safety issues and turning traffic causes congestion at peak times. We considered a fully signalised intersection. However, this option is less pedestrian friendly, reduces the amenity for the shops and may increase traffic using Aorangi Road as a cut through, which does not contribute to creating a safe cycling environment.

Nor'west Arc Cycleway Section 3 University to 157 Ilam Road

This is map 1 of 9. You can view the whole route, including the planned cycleway on Harewood Road, online ccc.govt.nz/haveyoursay, or pick up any of the other maps from Papanui, Riccarton and Fendalton Service Centres, Jellie Park Sports and Recreation Centre and Civic Offices

Option A

- The existing one-way cycleways on both sides of Ilam Road extend north to the intersection of Maidstone Road. The cycleways run behind the bus stops. Pedestrian crossings from the footpath to new bus shelters keep pedestrians and bus passengers separated and improves safety.
- Upgraded signals at the Creyke / Maidstone Road intersection stop turning vehicles, allowing cyclists and pedestrians to safely cross the intersection.
- The one-way cycleways continue on each side of Ilam Road to Memorial Avenue. The cycleways are protected by a raised separator. Parking on the east side of Ilam Road is removed and some parking on the west side is kept between Maidstone Road and Memorial Avenue.
- A 40km/h speed limit on Ilam Road increase safety for everyone.



Proposed one-way cycleway (Option A) on Ilam Road, near Hamilton Avenue

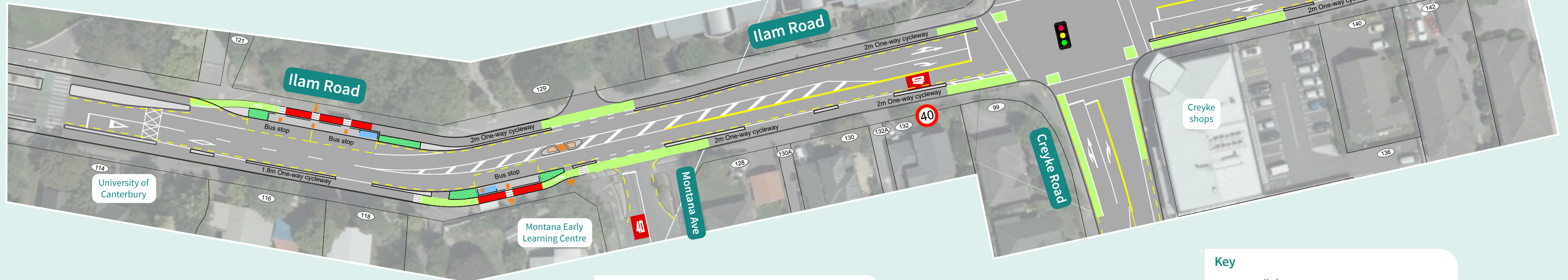

Nor'west Arc continues south

We want to know which of these options you prefer.
Go online to tell us what you think or use the contact details on reverse

See map 2

Option B

- The existing one-way cycleways on each side of Ilam Road will transition into a two-way cycleway on the west side at the existing zebra crossing. A two-way cycleway runs behind the bus stop. Pedestrian crossings from the footpath to a new bus shelter keep pedestrians and bus passengers separated and improves safety. The existing cycle lane on the east side of Ilam Road and pedestrian islands are removed.
- Upgraded signals at the Creyke / Maidstone Road intersection stop turning vehicles, allowing cyclists and pedestrians to safely cross the intersection.
- The cycleway crosses the intersection and continues on Ilam Road to Memorial Avenue, protected by a raised separator planted with trees. Parking on the west side of Ilam Road is removed and on the east side most parking is kept.
- A 40km/h speed limit on Ilam Road improves safety for everyone.



Proposed two-way cycleway (Option B) on Ilam Road, near Hamilton Avenue

