



**RECORD OF TITLE
UNDER LAND TRANSFER ACT 2017
FREEHOLD
Search Copy**



R. W. Muir
Registrar-General
of Land

Identifier **CB28F/1159**
Land Registration District **Canterbury**
Date Issued 06 June 1986

Prior References

CB11K/848 CB25F/748 CB26B/1032
CB473/285

Estate	Fee Simple
Area	1.1941 hectares more or less
Legal Description	Lot 1 Deposited Plan 46511 and Lot 1 Deposited Plan 46369 and Lot 2 Deposited Plan 13073 and Part Town Reserve 23 Town of Christchurch

Registered Owners

Park Terrace No. 2 Limited

Interests

Appurtenant hereto is a right of way over part Town Reserve shown as Westwood Terrace on plan hereon created by Conveyance 7712 (16D615)

Subject to Section 308 (4) Local Government Act 1974 (affects Lot 1 DP 46511 and Lot 1 DP 46369)

Land Covenant in Transfer 192337.1

5040359.1 Transfer creating the following easements in gross - 8.5.2001 at 2:34 pm

Type	Servient Tenement	Easement Area	Grantee	Statutory Restriction
Right to convey electric power	Part Town Reserve 23 Town of Christchurch and Lot 1 Deposited Plan 46369 and Lot 2 Deposited Plan 13073 and Lot 1 Deposited Plan 46511 - herein	A, B DP 301196	Orion New Zealand Limited	N/A

7591203.1 Notice of the registration of Bishopspark Retirement Village as a Retirement Village. Subject to section 22 of the Retirement Villages Act 2003 (which provides priority for the rights of the residents ahead of the rights of holders of security interests) - - 26.10.2007 at 9:00 am

Identifier

CB28F/1159

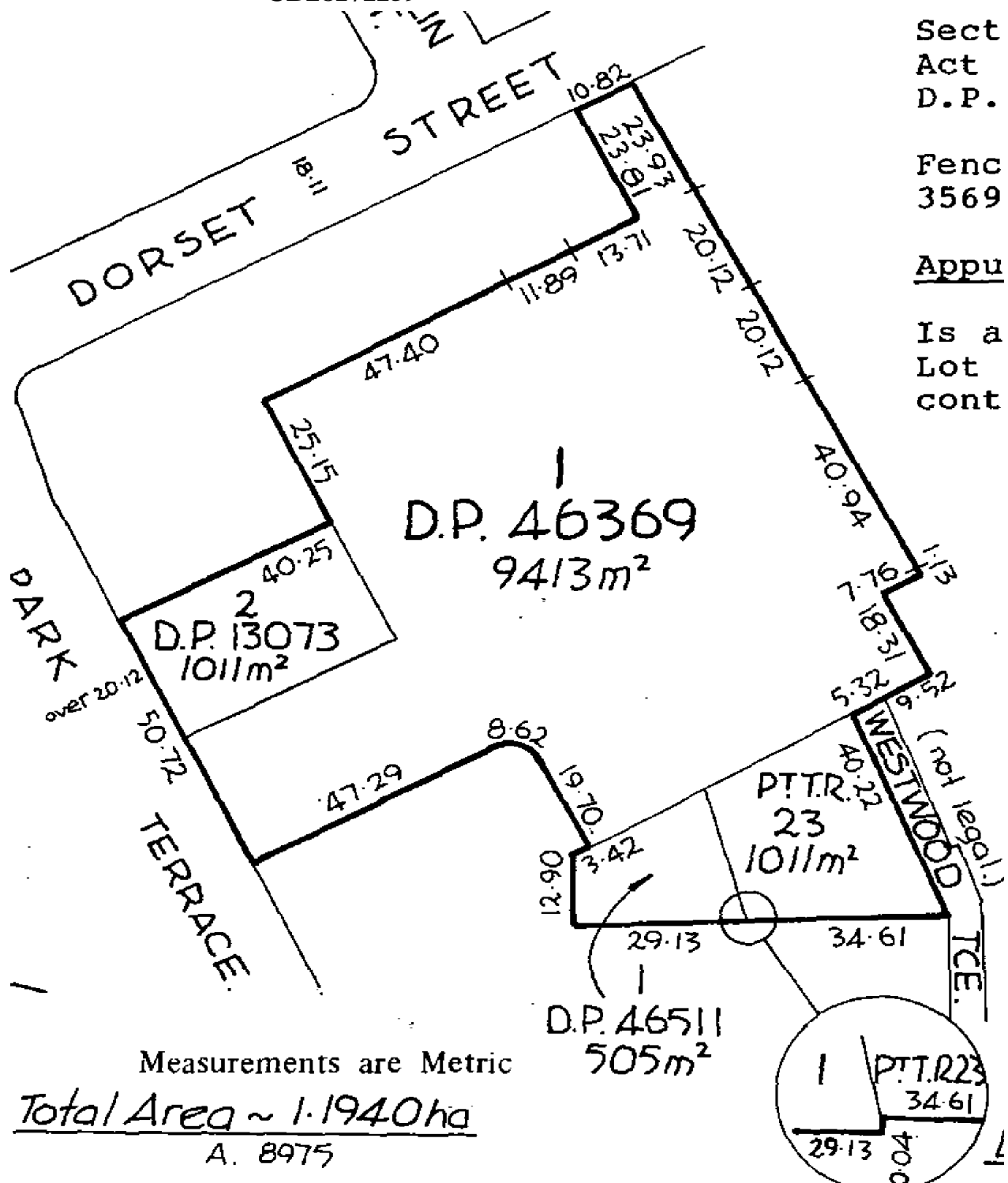



**RECORD OF TITLE
UNDER LAND TRANSFER ACT 2017
FREEHOLD
Search Copy**



R.W. Muir
Registrar-General
of Land

Identifier CB362/50
Land Registration District Canterbury
Date Issued 25 February 1925

Prior References

CB257/138

Estate	Fee Simple
Area	326 square metres more or less
Legal Description	Part Town Reserve 25 City of Christchurch

Registered Owners

Park Terrace No. 2 Limited

Interests

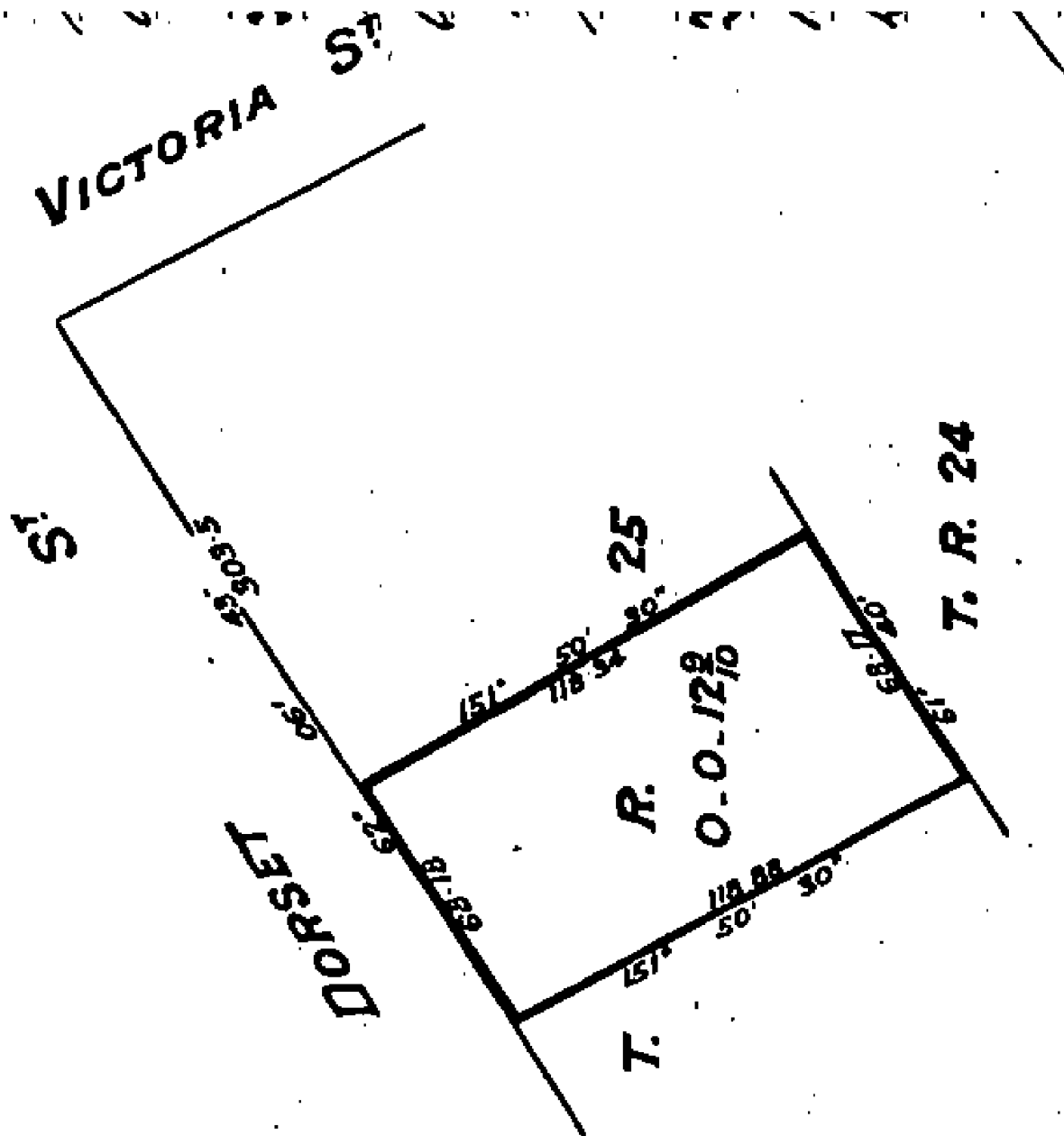

2/050



SUPPLEMENTARY RECORD SHEET UNDER UNIT TITLES ACT 1972

Search Copy

Identifier CB46D/74
Land Registration District Canterbury
Date Issued 10 August 2000

Plan Number

Subdivision of

Lot 1 Deposited Plan 77997

Prior References

CB44D/459

Unit Titles Issued

CB47D/1213	CB47D/1214	CB47D/1215	CB47D/1216
CB47D/1217	CB47D/1218	CB47D/1219	CB47D/1220
CB47D/1221	CB47D/1222	CB47D/1223	CB47D/1224
CB47D/1225	CB47D/1226	CB47D/1227	CB47D/1228
CB47D/1229	CB47D/1230	CB47D/1231	CB47D/1232
CB47D/1233	CB47D/1234	CB47D/1235	CB47D/1236
CB47D/1237	CB47D/1238	CB47D/1239	CB47D/1240
CB47D/1241	CB47D/1242	CB47D/1243	CB47D/1244
CB47D/1245	CB47D/1246	CB47D/1247	CB47D/1248
CB47D/1249	CB47D/1250	CB47D/1251	CB47D/1252
CB47D/1253	CB47D/1254	CB47D/1255	CB47D/1256
CB47D/1257	CB47D/1258	CB47D/1259	CB47D/1260
CB47D/1261	CB47D/1262	CB47D/1263	CB47D/1264
CB47D/1265	CB47D/1266	CB47D/1267	CB47D/1268
CB47D/1269	CB47D/1270	CB47D/1271	CB47D/1272
CB47D/1273	CB47D/1274	CB47D/1275	CB47D/1276
CB47D/1277	CB47D/1278	CB47D/1279	CB47D/1280
CB47D/1281	CB47D/1282	CB47D/1283	CB47D/1284
CB47D/1285	CB47D/1286	CB47D/1287	CB47D/1288
CB47D/1289	CB47D/1290	CB47D/1291	CB47D/1292
CB47D/1293	CB47D/1294	CB47D/1295	CB47D/1296
CB47D/1297	CB47D/1298	CB47D/1299	CB48A/1
CB48A/10	CB48A/11	CB48A/12	CB48A/13
CB48A/14	CB48A/15	CB48A/2	CB48A/3
CB48A/4	CB48A/5	CB48A/6	CB48A/7
CB48A/8	CB48A/9	CB48C/134	

Interests

OWNERSHIP OF COMMON PROPERTY

Pursuant to Section 47 Unit Titles Act 2010 -

(a) the body corporate owns the common property and

(b) the owners of all the units are beneficially entitled to the common property as tenants in common in shares proportional to the ownership interest (or proposed ownership interest) in respect of their respective

Identifier**CB46D/74**

units.

The above memorial has been added to Supplementary Record Sheets issued under the Unit Titles Act 1972 to give effect to Section 47 of the Unit Titles Act 2010.

Subject to Section 8 Mining Act 1971(affects part formerly in CT CB30K/261)

Subject to Section 5 Coal Mines Act 1979 (affects part formerly in CT CB30K/261)

Fencing Agreement in Transfer 361450.2 - 21.12.1981 at 10.10 am (affects part formerly in CT CB30K/261)

Land Covenant in Transfer 361450.2 - 21.12.1981 at 10.10 am (affects part formerly in CT CB23A/218)

395524.1 Notice under Section 354 Local Government Act 1974 - 9.8.1982 at 10.17 am (affects part formerly in CT CB23A/218)

Subject to a right (in gross) to convey electric power over part herein marked A on DP 81842 in favour of Orion New Zealand Limited created by Transfer A461748.2 - 9.6.2000 at 3.15 pm

A466019.10 Change of rules of the Body Corporate - produced 12.7.2000 at 3.37 pm and entered 10.8.2000 at 9.00 am

A476058.1 Change of rules of the Body Corporate - 2.10.2000 at 11.25 am

6260460.1 Change of rules of the Body Corporate - 21.12.2004 at 9:00 am

9363312.1 Certificate pursuant to Section 216(1) Unit Titles Act 2010 of a resolution by Body Corporate 82985 - 9.4.2013 at 10:34 am

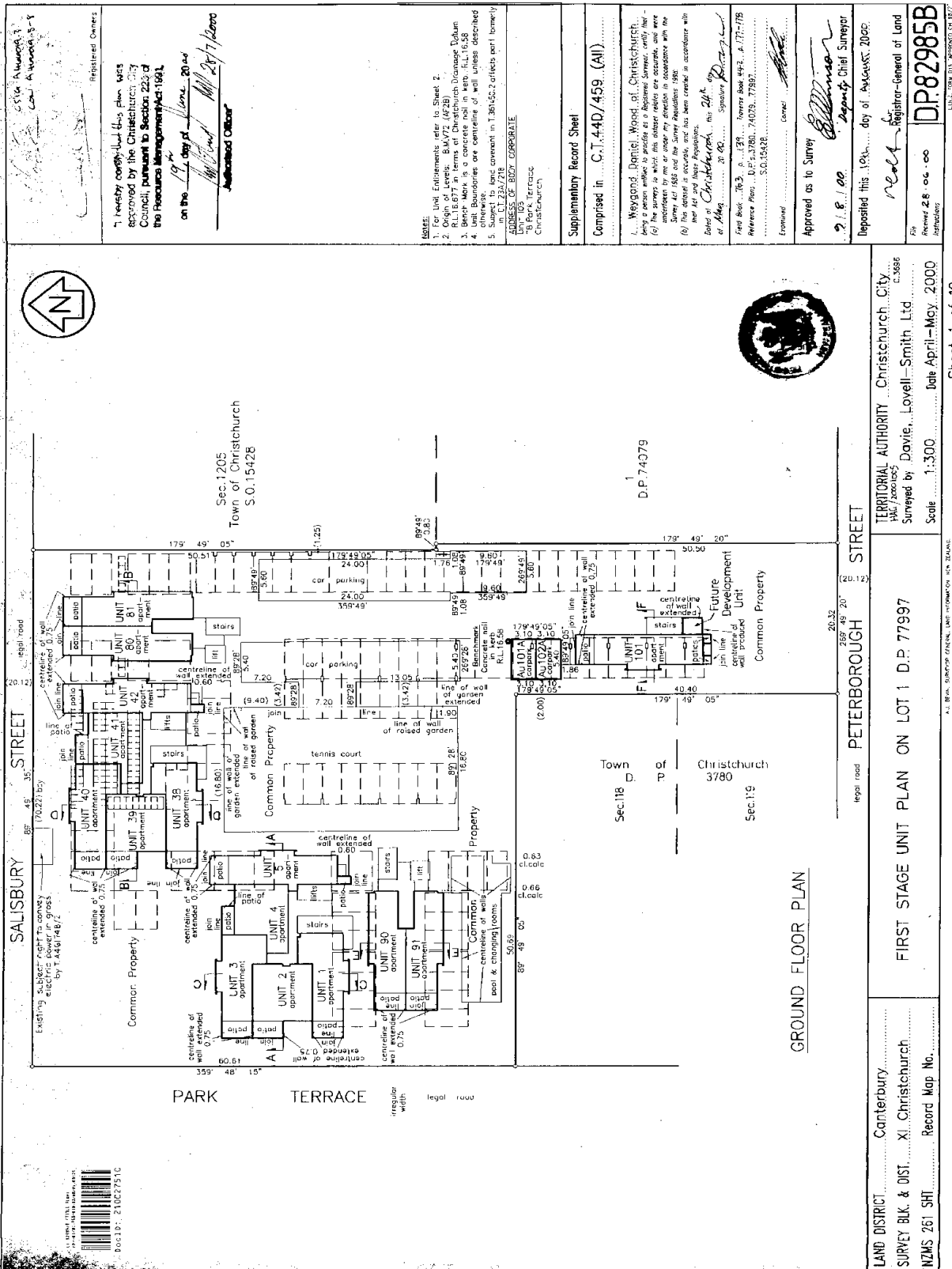

UNIT ENTITLEMENT				UNIT ENTITLEMENT				UNIT ENTITLEMENT				UNIT ENTITLEMENT			
Unit	Area	Height	Unit	Area	Height	Unit	Area	Height	Unit	Area	Height	Unit	Area	Height	Unit
470/1213	Unit 1	19.24	15.30	470/1213	Unit 2	19.24	15.30	470/1213	Unit 3	19.24	15.30	470/1213	Unit 4	19.24	15.30
470/1213	Unit 5	19.24	15.30	470/1213	Unit 6	19.24	15.30	470/1213	Unit 7	19.24	15.30	470/1213	Unit 8	19.24	15.30
470/1213	Unit 9	19.24	15.30	470/1213	Unit 10	19.24	15.30	470/1213	Unit 11	19.24	15.30	470/1213	Unit 12	19.24	15.30
470/1213	Unit 13	19.24	15.30	470/1213	Unit 14	19.24	15.30	470/1213	Unit 15	19.24	15.30	470/1213	Unit 16	19.24	15.30
470/1213	Unit 17	19.24	15.30	470/1213	Unit 18	19.24	15.30	470/1213	Unit 19	19.24	15.30	470/1213	Unit 20	19.24	15.30
470/1213	Unit 21	19.24	15.30	470/1213	Unit 22	19.24	15.30	470/1213	Unit 23	19.24	15.30	470/1213	Unit 24	19.24	15.30
470/1213	Unit 25	19.24	15.30	470/1213	Unit 26	19.24	15.30	470/1213	Unit 27	19.24	15.30	470/1213	Unit 28	19.24	15.30
470/1213	Unit 29	19.24	15.30	470/1213	Unit 30	19.24	15.30	470/1213	Unit 31	19.24	15.30	470/1213	Unit 32	19.24	15.30
470/1213	Unit 33	19.24	15.30	470/1213	Unit 34	19.24	15.30	470/1213	Unit 35	19.24	15.30	470/1213	Unit 36	19.24	15.30
470/1213	Unit 37	19.24	15.30	470/1213	Unit 38	19.24	15.30	470/1213	Unit 39	19.24	15.30	470/1213	Unit 40	19.24	15.30
470/1213	Unit 41	19.24	15.30	470/1213	Unit 42	19.24	15.30	470/1213	Unit 43	19.24	15.30	470/1213	Unit 44	19.24	15.30
470/1213	Unit 45	19.24	15.30	470/1213	Unit 46	19.24	15.30	470/1213	Unit 47	19.24	15.30	470/1213	Unit 48	19.24	15.30
470/1213	Unit 49	19.24	15.30	470/1213	Unit 50	19.24	15.30	470/1213	Unit 51	19.24	15.30	470/1213	Unit 52	19.24	15.30
470/1213	Unit 53	19.24	15.30	470/1213	Unit 54	19.24	15.30	470/1213	Unit 55	19.24	15.30	470/1213	Unit 56	19.24	15.30
470/1213	Unit 57	19.24	15.30	470/1213	Unit 58	19.24	15.30	470/1213	Unit 59	19.24	15.30	470/1213	Unit 60	19.24	15.30
470/1213	Unit 61	19.24	15.30	470/1213	Unit 62	19.24	15.30	470/1213	Unit 63	19.24	15.30	470/1213	Unit 64	19.24	15.30
470/1213	Unit 65	19.24	15.30	470/1213	Unit 66	19.24	15.30	470/1213	Unit 67	19.24	15.30	470/1213	Unit 68	19.24	15.30
470/1213	Unit 69	19.24	15.30	470/1213	Unit 70	19.24	15.30	470/1213	Unit 71	19.24	15.30	470/1213	Unit 72	19.24	15.30
470/1213	Unit 73	19.24	15.30	470/1213	Unit 74	19.24	15.30	470/1213	Unit 75	19.24	15.30	470/1213	Unit 76	19.24	15.30
470/1213	Unit 77	19.24	15.30	470/1213	Unit 78	19.24	15.30	470/1213	Unit 79	19.24	15.30	470/1213	Unit 80	19.24	15.30
470/1213	Unit 81	19.24	15.30	470/1213	Unit 82	19.24	15.30	470/1213	Unit 83	19.24	15.30	470/1213	Unit 84	19.24	15.30
470/1213	Unit 85	19.24	15.30	470/1213	Unit 86	19.24	15.30	470/1213	Unit 87	19.24	15.30	470/1213	Unit 88	19.24	15.30
470/1213	Unit 89	19.24	15.30	470/1213	Unit 90	19.24	15.30	470/1213	Unit 91	19.24	15.30	470/1213	Unit 92	19.24	15.30
470/1213	Unit 93	19.24	15.30	470/1213	Unit 94	19.24	15.30	470/1213	Unit 95	19.24	15.30	470/1213	Unit 96	19.24	15.30
470/1213	Unit 97	19.24	15.30	470/1213	Unit 98	19.24	15.30	470/1213	Unit 99	19.24	15.30	470/1213	Unit 100	19.24	15.30



LAND DISTRICT	Canterbury	TERRITORIAL AUTHORITY	Christchurch City
SURVEY BLK. & DIST.	XI Christchurch	Surveyed by	Davie, Lovell-Smith Ltd
NZMS 261 SH	Record Map No.	Scale	Not to Scale
		Date	April-May 2000
		Sheet	2 of 10

Comprising in	Weyland Daniel Wood of Christchurch
	being the land shown in the plan deposited in the office of the Registrar-General of Land under the Survey Act 1986 and the Survey Regulations 1986.
	(a) The survey is in accordance with the Survey Act 1986 and the Survey Regulations 1986.
	(b) The survey is in accordance with the Survey Act 1986 and the Survey Regulations 1986.
	(c) The survey is in accordance with the Survey Act 1986 and the Survey Regulations 1986.
	(d) The survey is in accordance with the Survey Act 1986 and the Survey Regulations 1986.
	(e) The survey is in accordance with the Survey Act 1986 and the Survey Regulations 1986.
	(f) The survey is in accordance with the Survey Act 1986 and the Survey Regulations 1986.
	(g) The survey is in accordance with the Survey Act 1986 and the Survey Regulations 1986.
	(h) The survey is in accordance with the Survey Act 1986 and the Survey Regulations 1986.
	(i) The survey is in accordance with the Survey Act 1986 and the Survey Regulations 1986.
	(j) The survey is in accordance with the Survey Act 1986 and the Survey Regulations 1986.
	(k) The survey is in accordance with the Survey Act 1986 and the Survey Regulations 1986.
	(l) The survey is in accordance with the Survey Act 1986 and the Survey Regulations 1986.
	(m) The survey is in accordance with the Survey Act 1986 and the Survey Regulations 1986.
	(n) The survey is in accordance with the Survey Act 1986 and the Survey Regulations 1986.
	(o) The survey is in accordance with the Survey Act 1986 and the Survey Regulations 1986.
	(p) The survey is in accordance with the Survey Act 1986 and the Survey Regulations 1986.
	(q) The survey is in accordance with the Survey Act 1986 and the Survey Regulations 1986.
	(r) The survey is in accordance with the Survey Act 1986 and the Survey Regulations 1986.
	(s) The survey is in accordance with the Survey Act 1986 and the Survey Regulations 1986.
	(t) The survey is in accordance with the Survey Act 1986 and the Survey Regulations 1986.
	(u) The survey is in accordance with the Survey Act 1986 and the Survey Regulations 1986.
	(v) The survey is in accordance with the Survey Act 1986 and the Survey Regulations 1986.
	(w) The survey is in accordance with the Survey Act 1986 and the Survey Regulations 1986.
	(x) The survey is in accordance with the Survey Act 1986 and the Survey Regulations 1986.
	(y) The survey is in accordance with the Survey Act 1986 and the Survey Regulations 1986.
	(z) The survey is in accordance with the Survey Act 1986 and the Survey Regulations 1986.

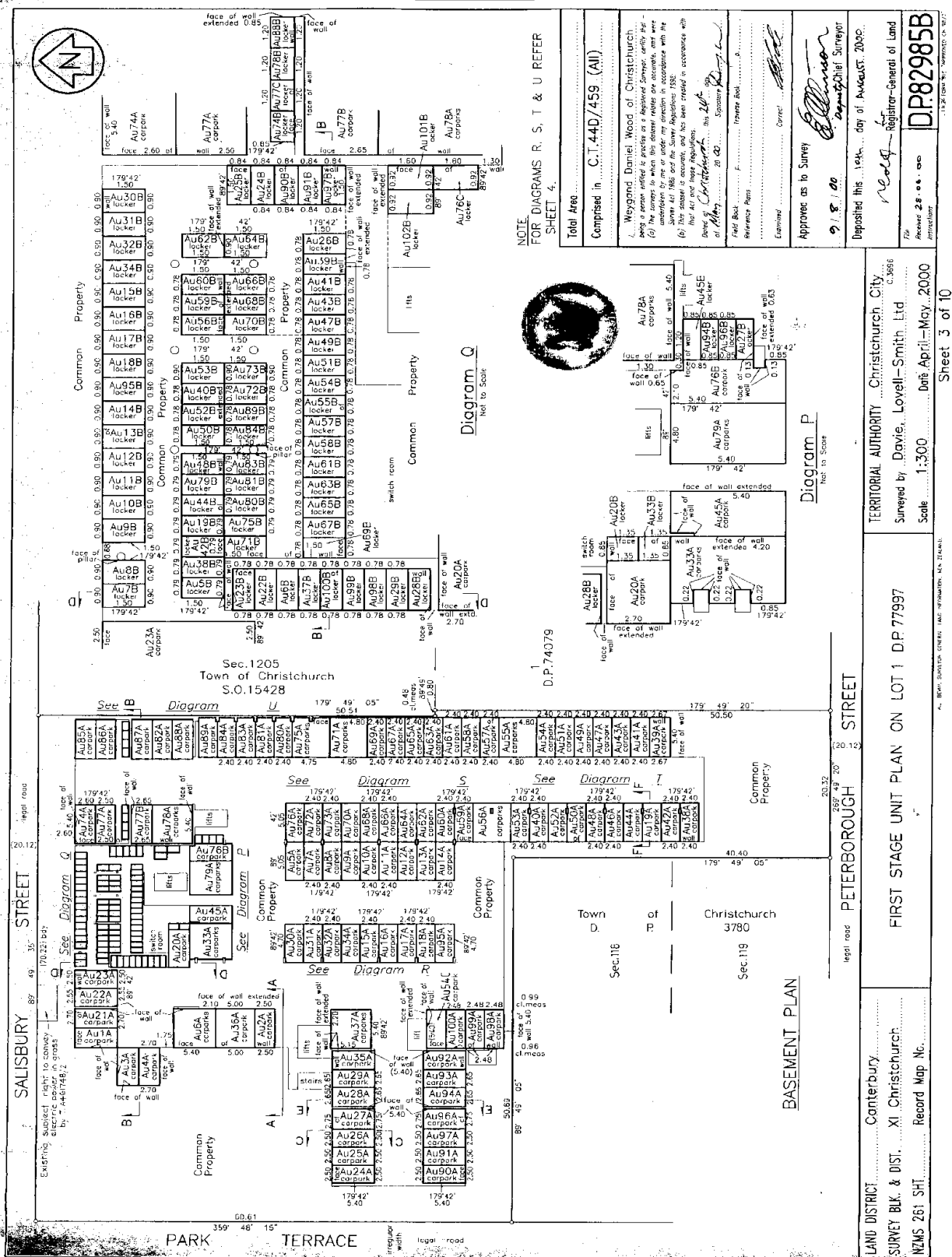



0.011 miles

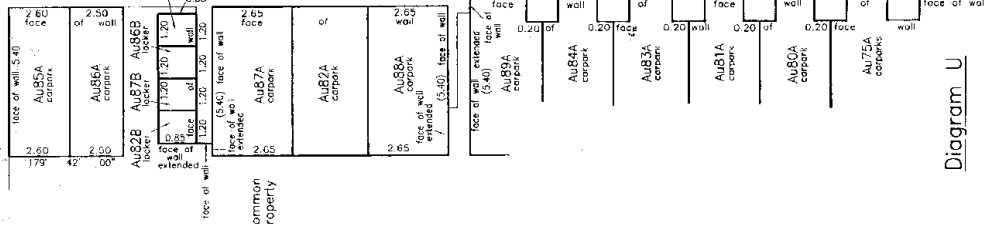

Diagram U

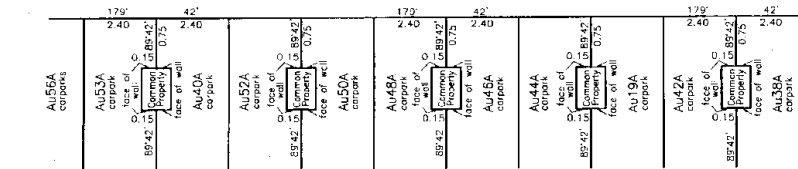

Diagram I

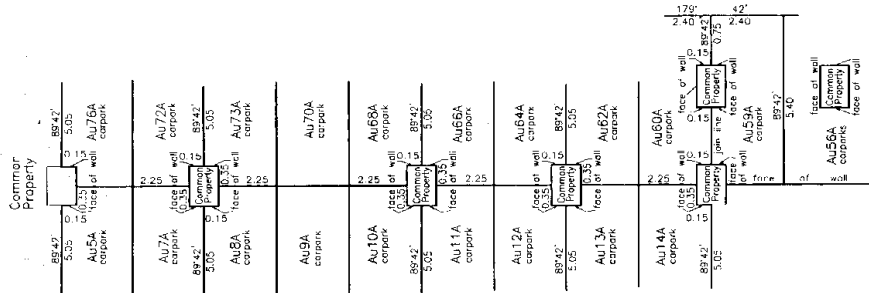

Diagram S

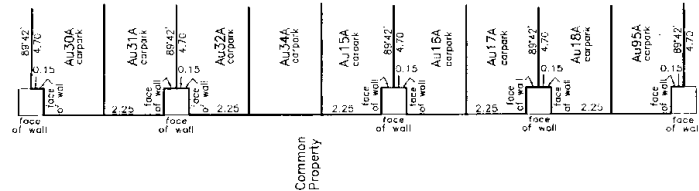

Diagram R

Total Area	
Comprised in	
Weyland, Daniel, Wood of Christchurch	
(c) The survey in which this district relates are accurate, and were undertaken by me or under my direction in accordance with the provisions of the Survey Regulations 1957.	
(d) The district is shown as being created in accordance with the Act and these Regulations.	
Date of Christchurch	24th day of May 2000
Signature of Surveyor	Signature of Daniel Wood
Field Book	Reference Plans
Estimated	Correct
Approved as to Survey	9.8.00
Deposited this 9th day of November 2000	
Registered as to Land	
For	DP82985B

TERRITORIAL AUTHORITY Christchurch City
 Surveyed by Davie, Lovell-Smith Ltd
 Scale Not to Scale Date April-May 2000

DIAGRAMS R, S, T & U

LAND DISTRICT Canterbury
 SURVEY BLK. & DIST. XI Christchurch
 NZMS 261 SH. Record Map No.

Sheet 4 of 10

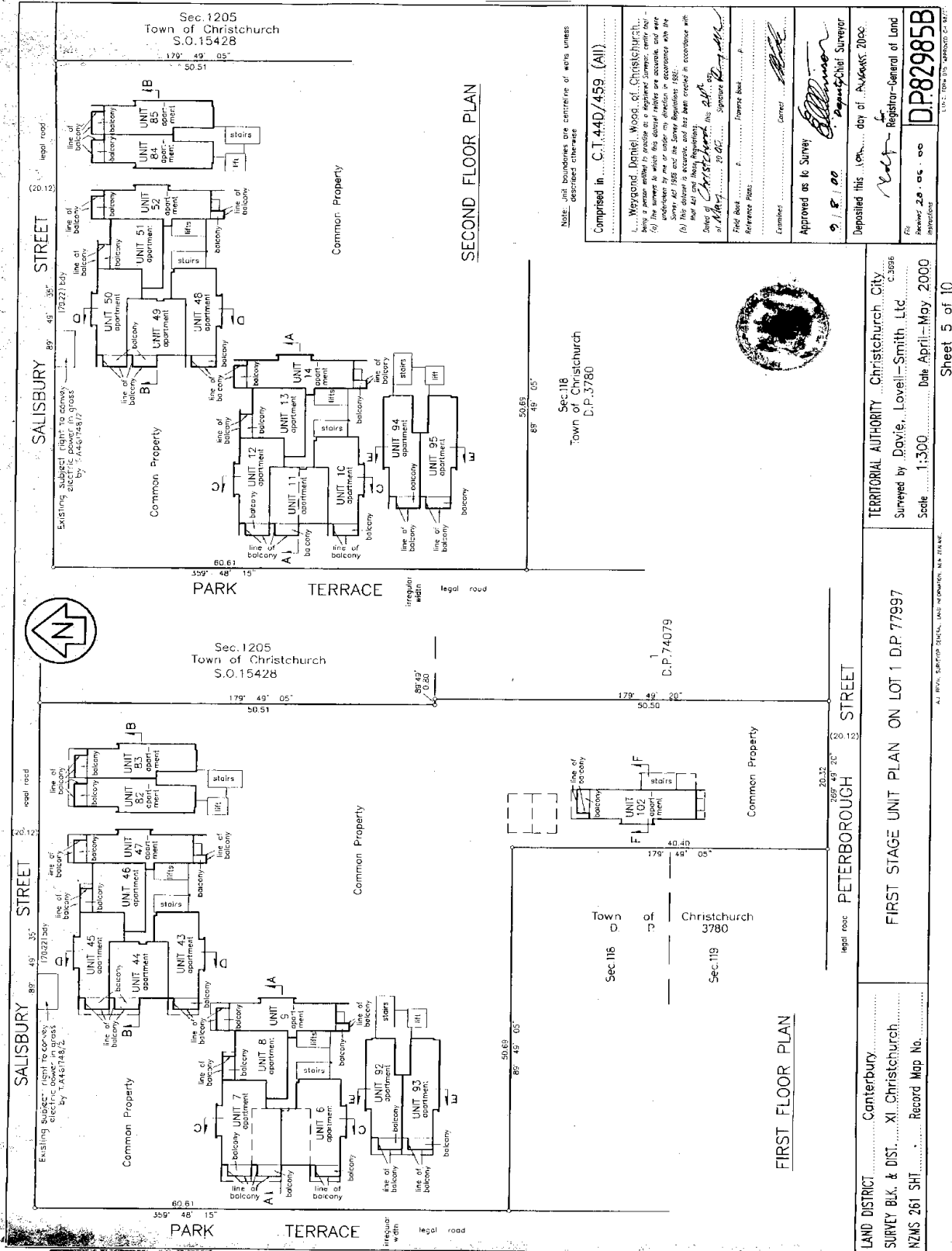

Note: Unit boundaries are tentative of works unless described otherwise

Comprised in C.T. 440/459 (All)

Wayward Daniel Wood of Christchurch...
(a) This survey is made in accordance with the Survey Act 1980 and the Survey Regulations 1980.
(b) This survey is accurate and has been created in accordance with the Survey Act 1980 and the Survey Regulations 1980.

Survey of Christchurch this day of May 2000
Surveyor

Field Book Reference Plans

Comprises

Approved as to Survey

Deposited this day of May 2000

Register-General of Land

DP82985B

Scale 1:300

Date April-May 2000

Sheet 5 of 10

TERRITORIAL AUTHORITY Christchurch City

Surveyed by Davie, Lovell-Smith Ltd

Scale 1:300

Date April-May 2000

Sheet 5 of 10

Sec 118 Town of Christchurch D.P. 3780

Sec 119 Town of Christchurch D.P. 3780

Sec 1205 Town of Christchurch S.O. 15428

Sec 1205 Town of Christchurch S.O. 15428

Sec 1205 Town of Christchurch S.O. 15428

Sec 1205 Town of Christchurch S.O. 15428

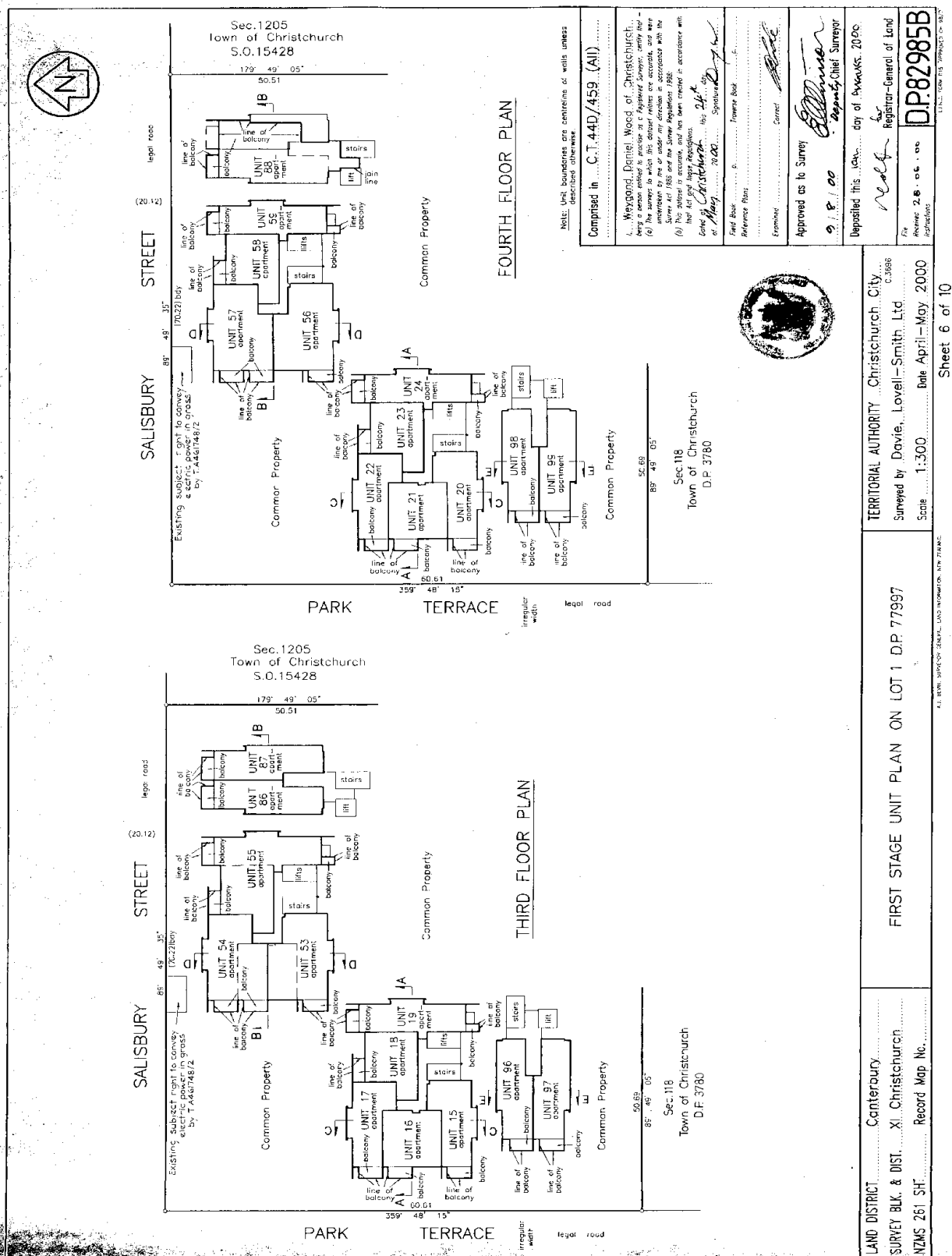



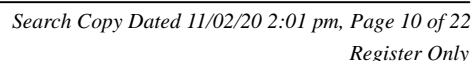

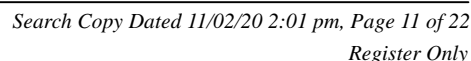

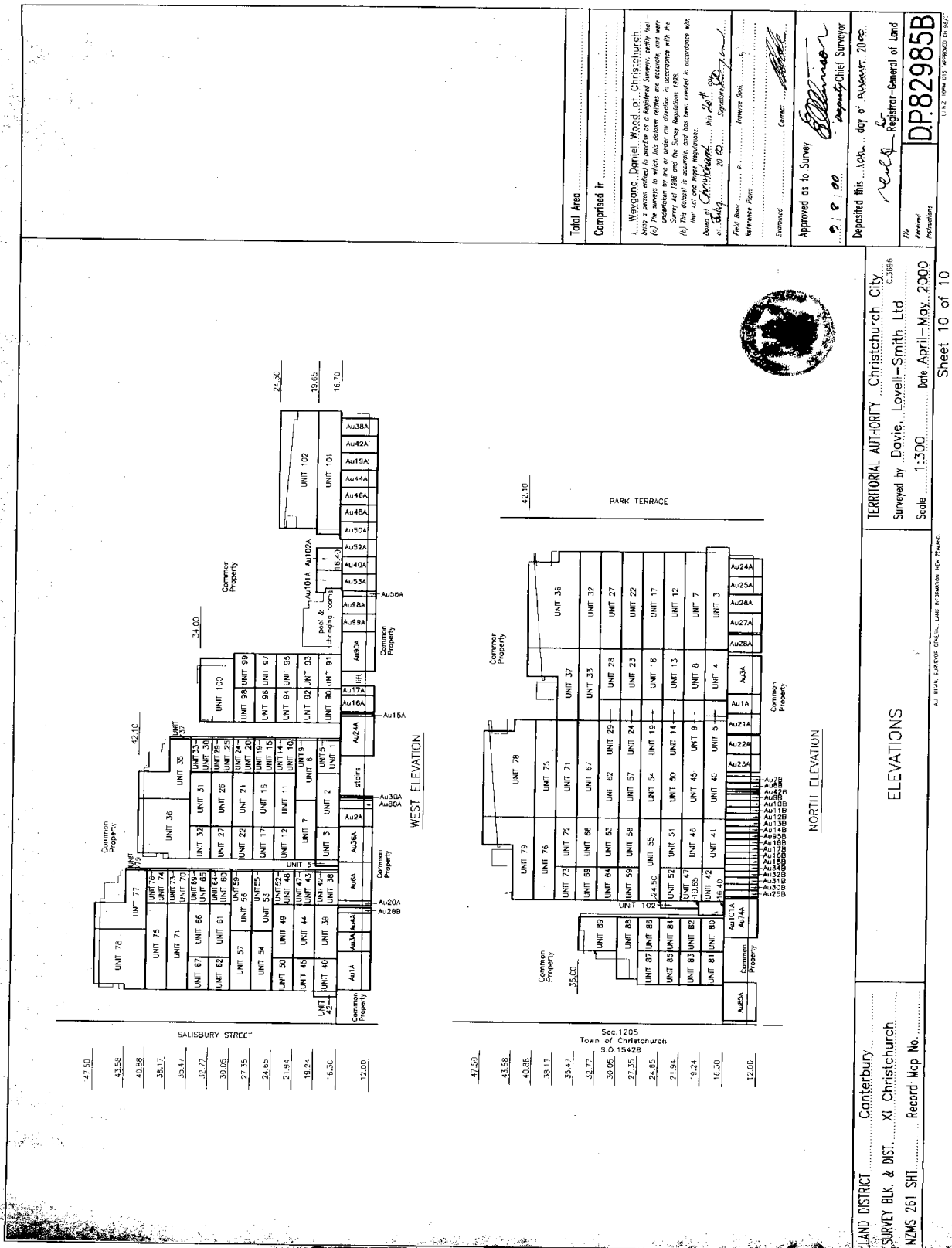

Total Area
Comprised in

I, Waymond Daniel Wood of Christchurch, being duly sworn, depose and say that the foregoing is a true and correct copy of the original survey as the same appears in my office, and that the same is correct in accordance with the Survey Act 1986 and the Survey Regulations 1986.

Given at Christchurch this 24 day of July 2010.

Field Book 2010 Reference Pages 1 to 10 Imprime Book 1

Examined [Signature] Corner [Signature]

Approved as to Survey [Signature] 9.1.10 Deputy Chief Surveyor

Deposited this 10th day of August 2010

File DP82985B

LAND DISTRICT Canterbury TERRITORIAL AUTHORITY Christchurch City

SURVEY BLK & DIST. XI Christchurch Surveyed by Davie, Lovell-Smith Ltd C-3556

NAMS 261 SHT Record Map No. 1:300 Date April-May 2000

Scale 1:300 Sheet 10 of 10

ELEVATIONS

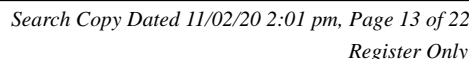

Comprised in	<p>1. <u>Waymond Daniel Wood of Christchurch</u> being a person entitled in possession as a registered Surveyor, partly by Act, the Surveyors to make this District relative correct, and were authorized to run & under my direction in accordance with the Survey Act 1956 and the Survey Regulations 1959:</p> <p>(b) <u>the land</u> <u>has been created in accordance with</u> <u>their Act and these Regulations.</u></p> <p>Dated at <u>Christchurch</u> the <u>26th</u> day of <u>July</u> 20<u>00</u> Signature <u>[Signature]</u></p> <p>Field Book <u>3</u> Trencher Book <u>3</u></p> <p>Reference Plans</p> <p>Examined <u>[Signature]</u> Correct</p> <p>Approved as to Survey <u>[Signature]</u></p> <p><u>9 / 8 / 00</u> Deputy Chief Surveyor</p> <p>Deposited this <u>16th</u> day of <u>AUGUST</u>, 20<u>00</u>.</p> <p><u>redg</u> for Registrar-General of Land</p> <p>File No. <u>DP82985A</u></p> <p>Map No. <u>DP82985A</u></p>			
--------------	---	--	--	--

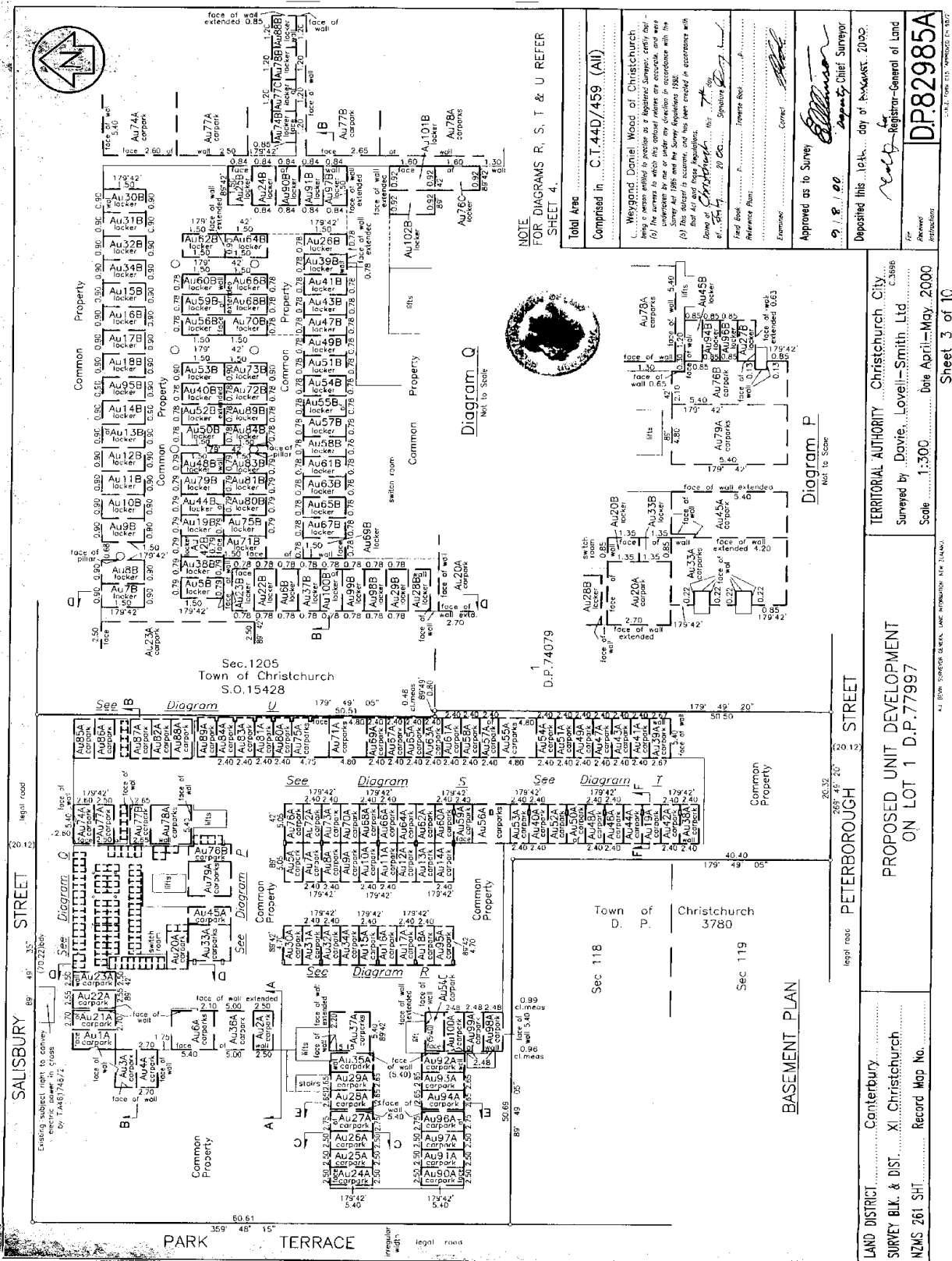

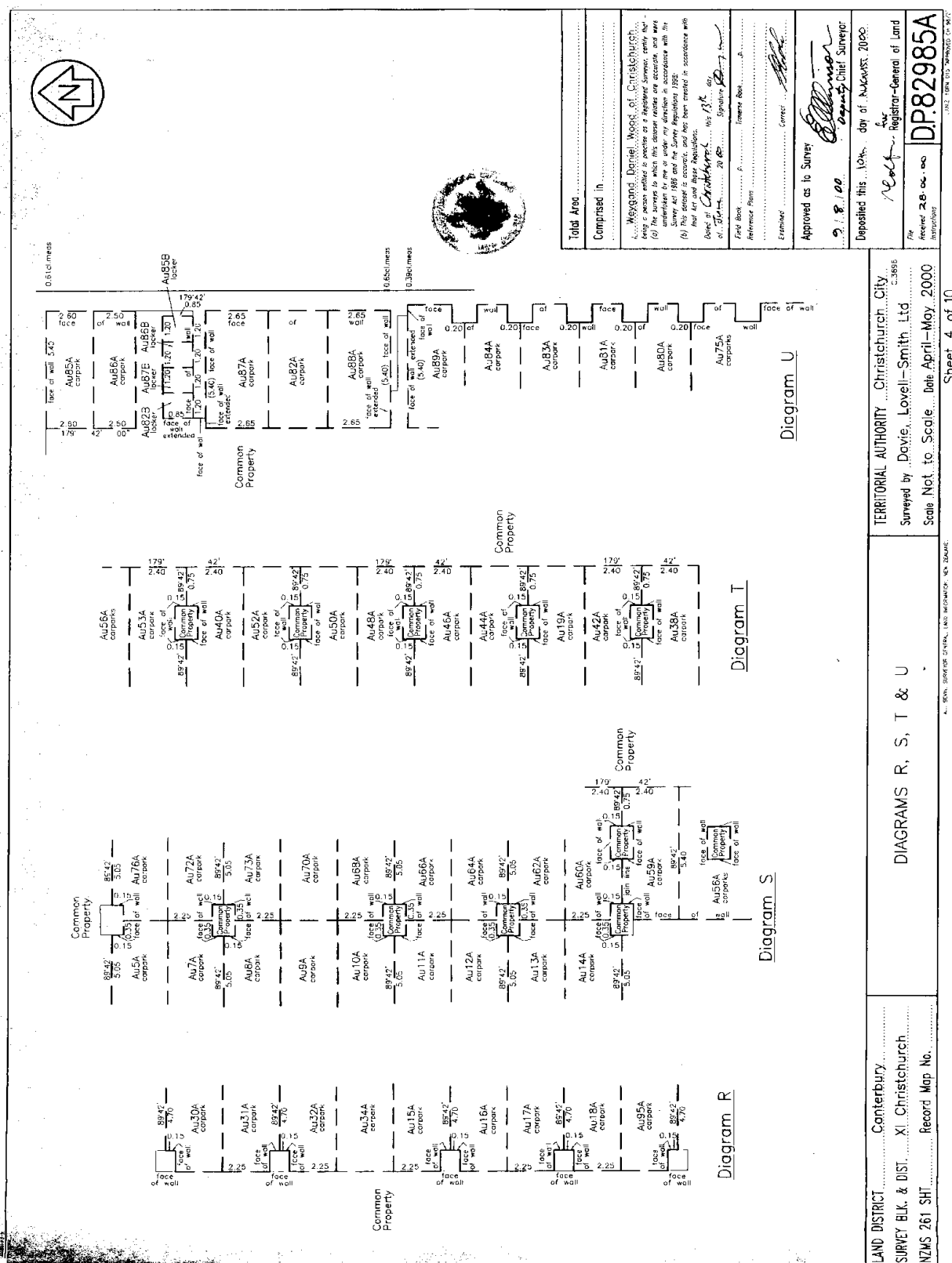

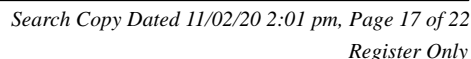

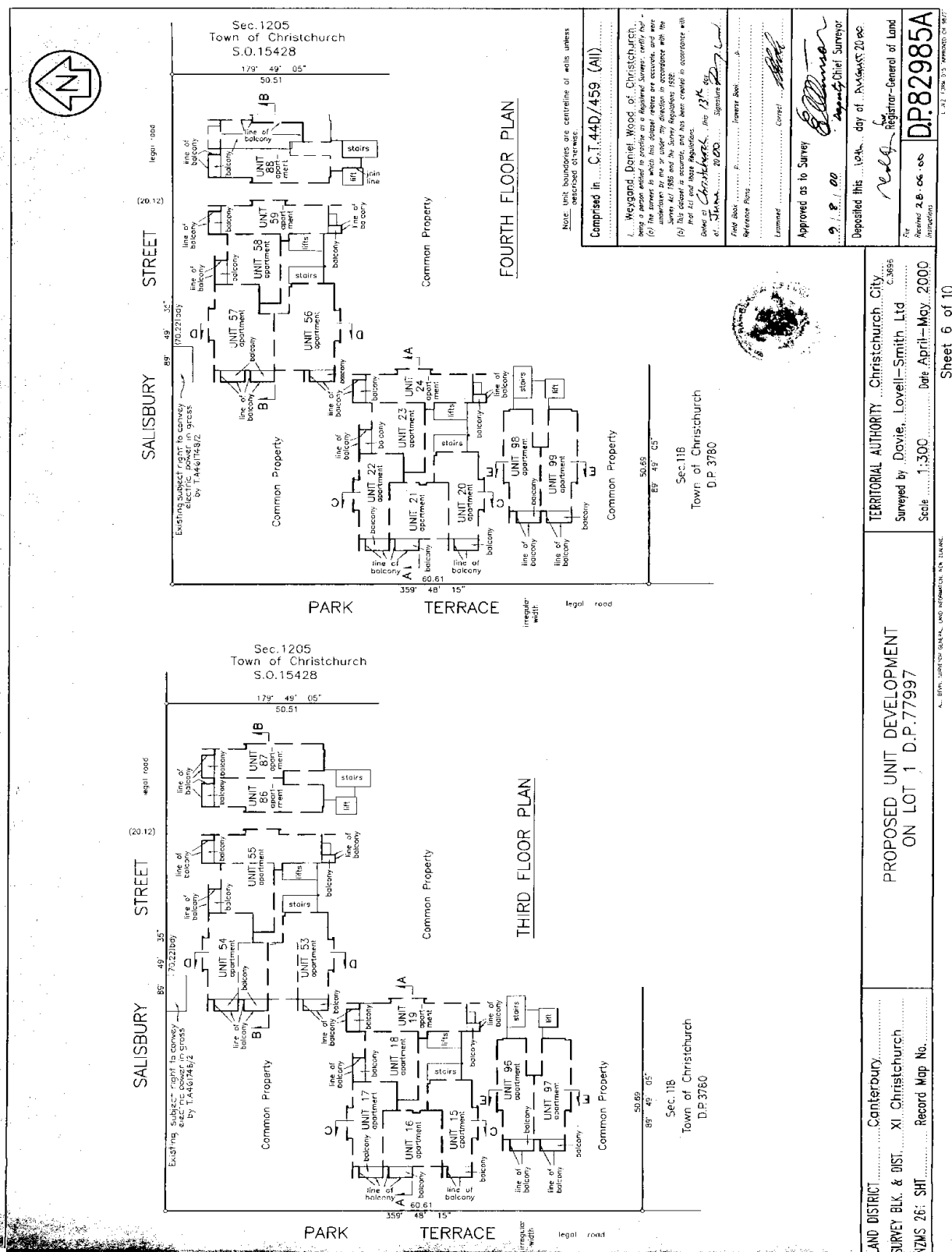

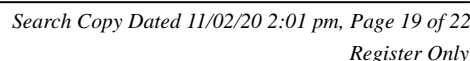

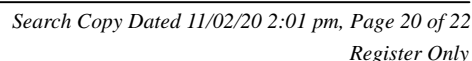

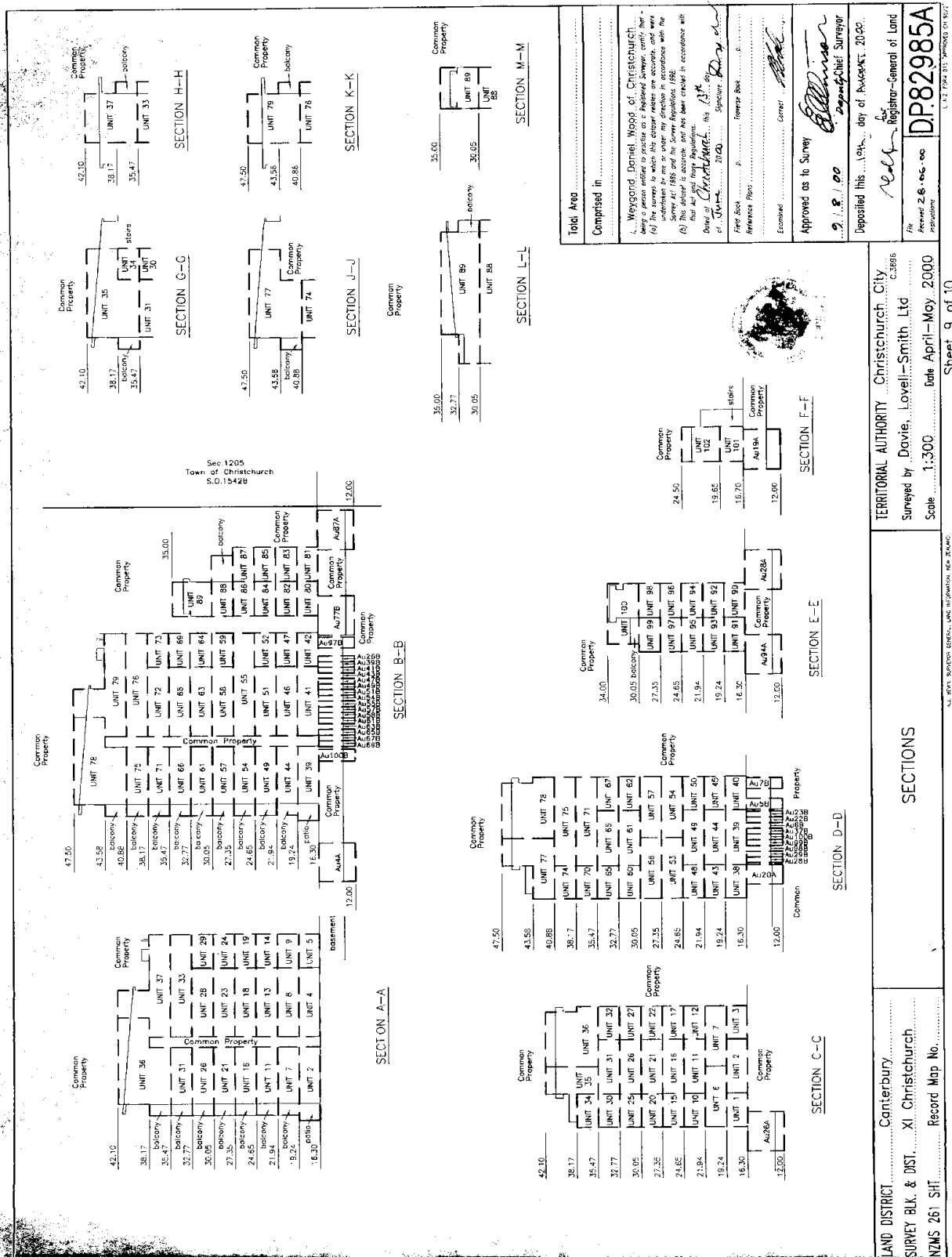

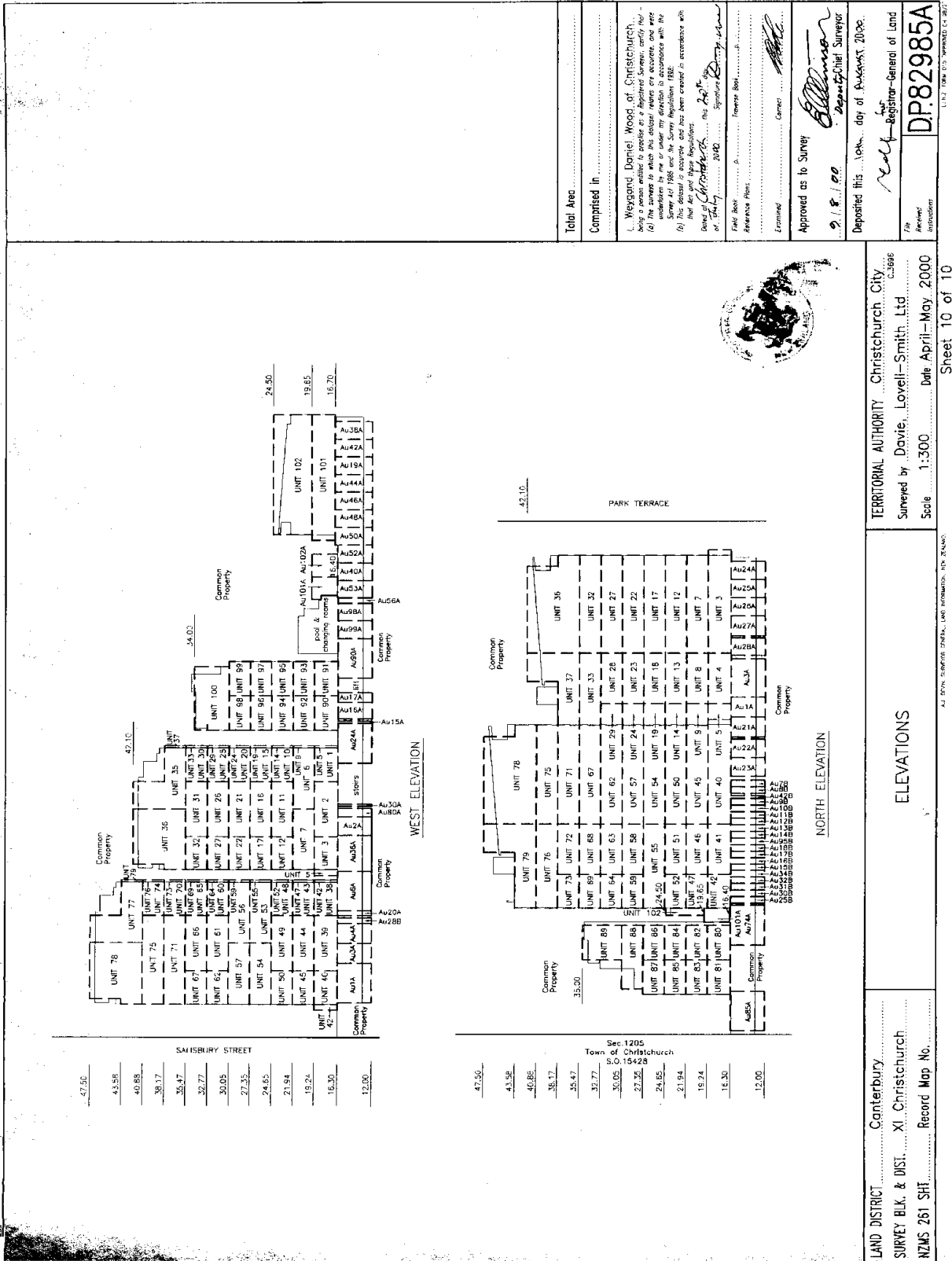

LAND DISTRICT	Canterbury	TERRITORIAL AUTHORITY	Christchurch City
SURVEY BLK. & DIST.	XI Christchurch	Surveyed by	Davie, Lovell-Smith Ltd
NZMS 251 SH1	Record Map No.	Scale	1:300
		Date	April-May 2000
		Sheet	10 of 10

Total Area	
Computed in	
<p>L. Weyland, Daniel Wood, of Christchurch, being a person entitled to practice as a Registered Surveyor, certify that (a) the survey to which this consent relates is accurate, and was made in accordance with the Survey Regulations 1982, and (b) this consent is accurate and has been created in accordance with the Act and these Regulations.</p> <p>Dated at Christchurch this 20th day of May 2000.</p> <p>or, 20th May 2000. Signature: <i>[Signature]</i></p>	
Field Book	Reference Plans
Examined	Correct
Approved as to Survey	
Deposited this	10th day of August 2000.
By	<i>[Signature]</i>
Registrar-General of Land	
File	
Reference	
Instructions	
	DP:82985A