

## *Ferry Road Movement and Streetscape Improvements at Woolston Village*

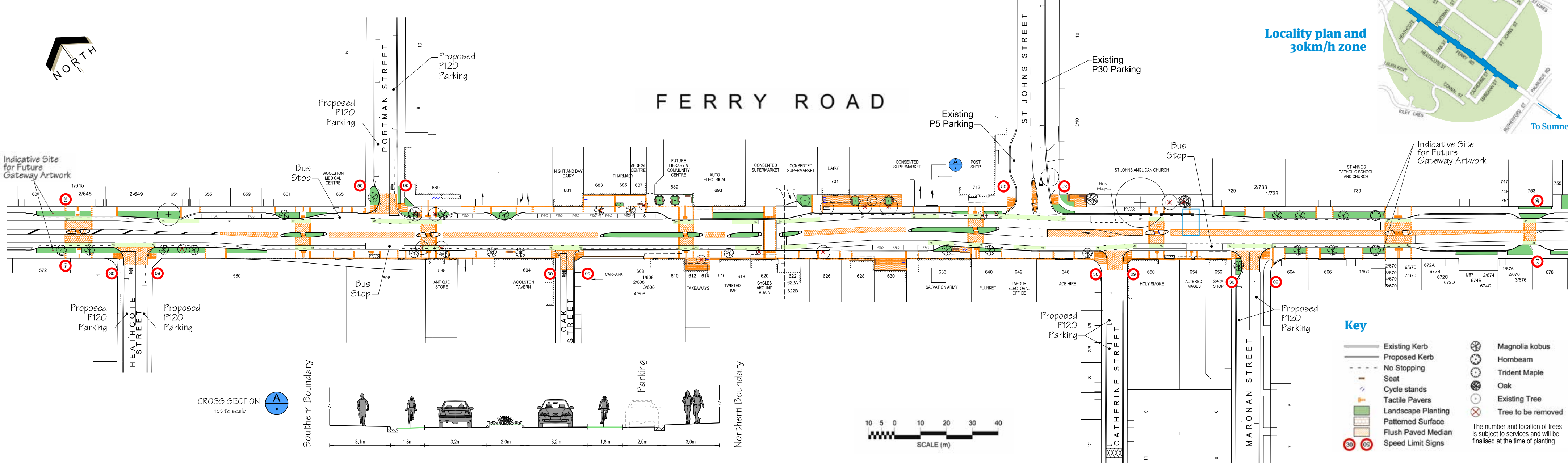

Philippa Upton  
Engagement Advisor  
Christchurch City Council  
PO Box 73013  
Christchurch Mail Centre  
Christchurch 8154  
Phone 941 8808  
Email [philippa.upton@ccc.govt.nz](mailto:philippa.upton@ccc.govt.nz)

# Proposed concept for Ferry Road at Woolston Village





# Proposed concept for Ferry Road at Woolston Village

*We want to know what you think* about plans to enhance Woolston Village by creating a more inviting public space and making this section of Ferry Road safer for pedestrians, cyclists and motorists.

Community feedback as part of the 2014 Ferry Road Master Plan highlighted the need for improvements around Woolston Village. Based on what local residents told us, the Council is proposing a series of street enhancements that highlight the distinctive industrial character of the village centre, balance the needs of road users and attract more people to visit and spend time in Woolston Village.

### Summary of improvements

Key changes and improvements proposed as part of the Woolston Village upgrade include:

- Creating a pedestrian-focused environment, with extra crossing points at key locations and paving that guides people to public spaces.
- Installing a flush paved median strip along the centre of the road to help identify the suburban centre and reduce vehicle speeds.
- Introducing cycle lanes and additional cycle parking.
- Introducing a 30km/h speed zone.
- Directing motorists to alternative nearby parking sites to make the area safer for pedestrians and cyclists, and make space for more landscaping. This would reduce the number of parking spaces on this section of Ferry Road from 77 to 21, as well as five parking spaces from side streets.
- Enhancing the look and feel of the area by planting trees of various sizes and improving landscape planting. The aim is to make the street appear narrower and achieve a “village feel”.
- Upgrading street furniture like seats, rubbish bins and cycle stands, and improving street lighting.
- Creating “gateways” that clearly show where the village begins and ends.

### Key points we have thought about

The Ferry Road Master Plan indicated public support for enhancements to Woolston Village, which will encourage people to visit and improve road safety along this busy stretch of Ferry Road. The proposal outlined in this document considers existing strategic plans for the city and is based on research of the key issues – however, we need to know what you think about our proposal before we go any further.

#### PEDESTRIANS

Improved street crossings, pedestrian islands and wider footpaths will make it safer and more pleasant for pedestrians to visit the village.

#### CYCLISTS

Painted cycle lanes and advanced cycle stop boxes at the traffic lights will make the road safer for cyclists.

#### SPEED REDUCTION AND ROAD LANES

Narrowing the road and introducing a 30km/h speed zone aims to encourage motorists to slow down through the busy village and make it safer for all road users.

#### LIGHTING, FURNITURE AND LANDSCAPING

Street lighting will be improved, new seats, rubbish bins and cycle stands installed and a variety of trees and plants will help make the area a more appealing place to visit and spend time. The materials and planting palette will reflect the character and heritage of the village. The plan proposes 16 trees to be removed and replaced with 35 new trees, however the number and location of trees is subject to the placement of underground services and will be finalised at the time of planting.



#### HISTORIC AND CULTURAL CONTEXT

Based on feedback through the 2014 Ferry Road Master Plan consultation process, the design for the new Woolston Village project draws heavily on the industrial heritage of the area. The colour and tones of the landscaping and street furniture have also been chosen to reflect the Port Hills and heritage aspects. References to the area’s early Maori history will also be incorporated in final plans.

#### PARKING

The proposed redirection of motorists to off-street parking and side roads aims to make the area safer for everyone and improve the way it looks and feels. We commissioned an independent parking survey which confirmed that the parking proposed for removal could be accommodated either on side roads or through existing off-street spaces (e.g. on Heathcote, Catherine, and Portman Streets). Clear signage would direct motorists to parking areas on side roads. Remaining on-street parking on Ferry Road will be a mix of P30 and P60 spaces, and P30 and P120 spaces on side roads to encourage parking turnover.

### Trees



### Shopper survey

A survey of 204 shoppers in Woolston Village in February 2016 helped us understand how people get to the shops and their general habits.

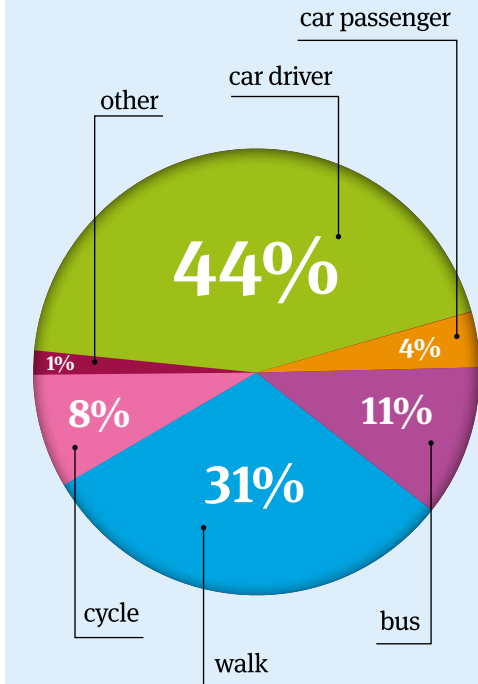

#### How people currently get to Woolston Village

The survey showed how frequently each of these groups visited Woolston. Seventy six per cent of walkers visited the shopping area two to three times a week, which is the definition of a regular visitor, as did 75 per cent of cyclists and 67 per cent of bus users. This is compared to 52 per cent of drivers and 38 per cent of car passengers.

Most of the people surveyed were in the area briefly to visit the shops with 75 per cent staying less than 30 minutes.

People driving cars indicated that parking was important, however 60 per cent of drivers had no preference between on-street parking and off-street parking. Seventy per cent of drivers indicated that parking restrictions were important. The peak occupancy of parking spaces on Ferry Road during the survey was 56 per cent, with typical occupancy of parking spaces being below 50 per cent.

### Parking

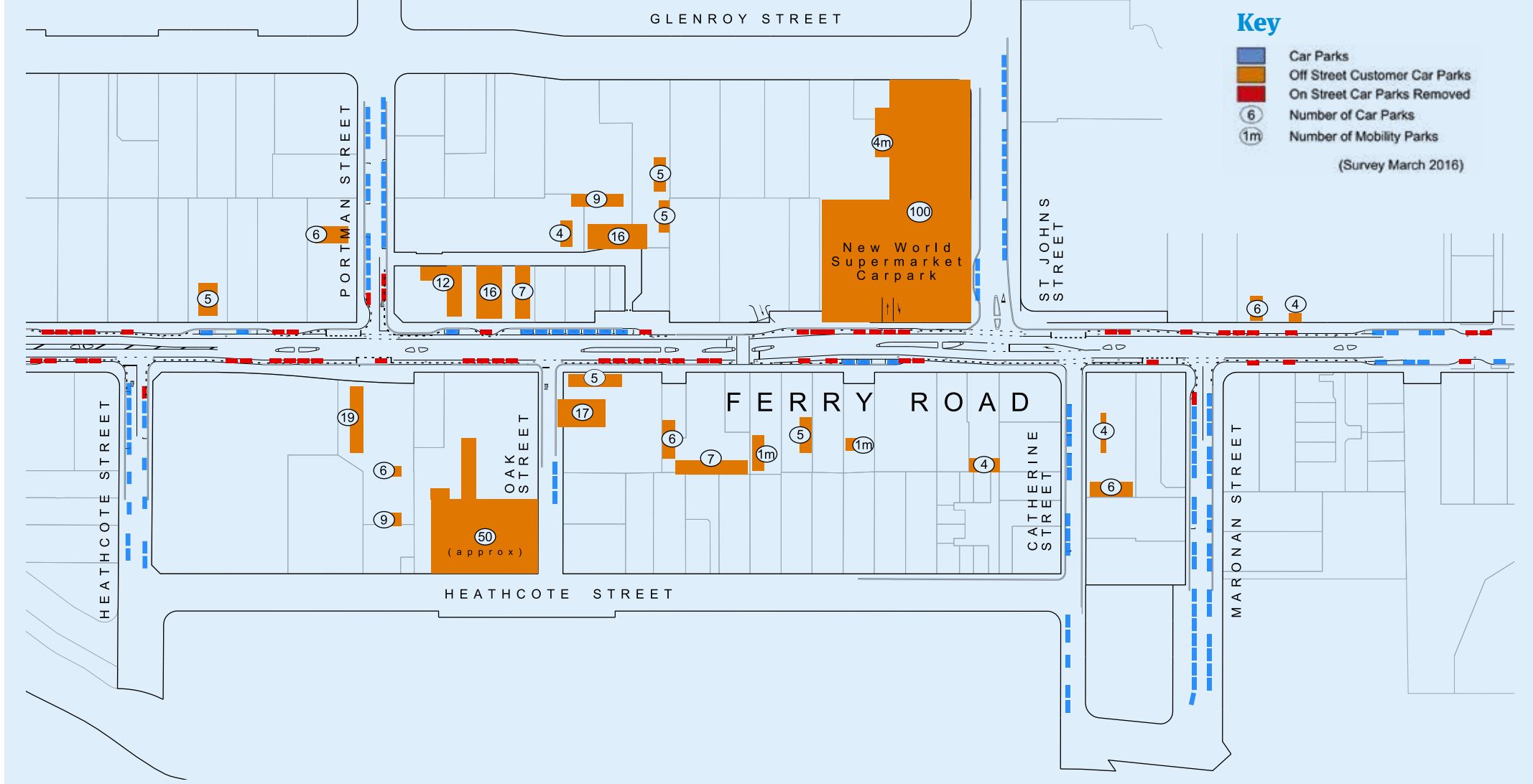

### Timeline



### HAVE YOUR SAY

This concept plan attempts to address the public call for improvements to the village through the Ferry Road Master Plan, while balancing the requirements of a safer and more attractive environment with the need for parking near businesses. It is anticipated that the proposed improvements will attract more people to spend time in the village and therefore benefit commercial activities.

It is important that you tell us what you think of the concept plan before we go any further.

**Please make sure your comments reach us by 5pm on Wednesday 8 June.**

If you give us your contact details on the submission form, we will send you the final plan and a summary of consultation feedback before the decision is made. We will also let you know the date and time of the meeting where this plan will be considered by the Hagley/Ferrymead Community Board.

### Landscape concept

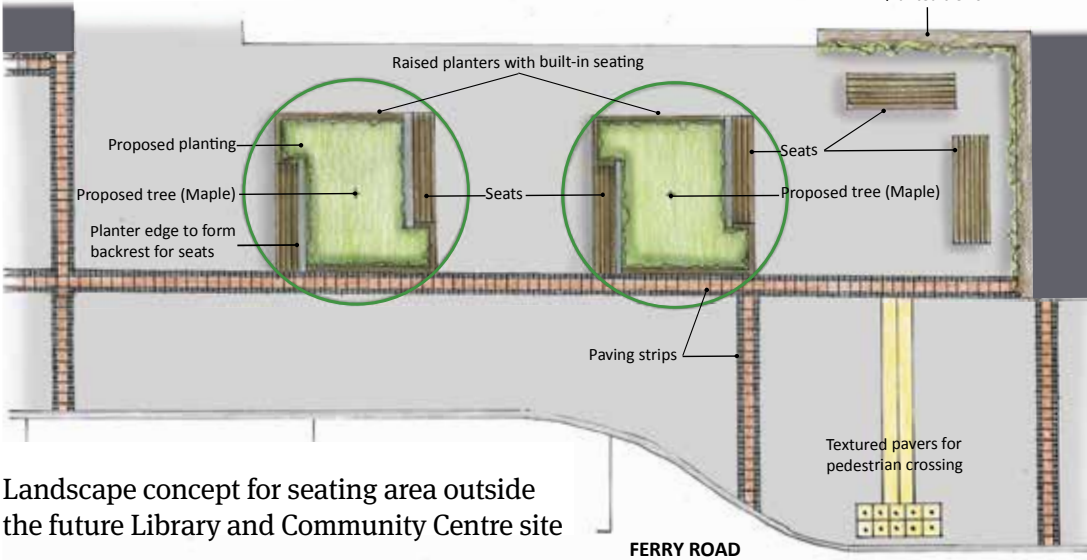

Landscape concept for seating area outside the future Library and Community Centre site

### COME AND TALK TO US

The project team will be available to discuss this project and answer any questions at the **St John's Church Hall on Wednesday 25 May**. Please come to visit us here **any time between 3.30pm and 6.30pm**, and there will be a short presentation at 5pm.

### CONTACT

Philippa Upton, *Engagement Advisor*  
Christchurch City Council, PO Box 73013, Christchurch Mail Centre, Christchurch 8154  
Phone 941 8808 | Email [philippa.upton@ccc.govt.nz](mailto:philippa.upton@ccc.govt.nz)

**FURTHER INFORMATION**  
[ccc.govt.nz/woolston](http://ccc.govt.nz/woolston)