

Background (continued from front page)

A new working party was established by the Shirley-Papanui Community Board in November 2015. The working party is made up of representatives from the, St Albans Residents Association, St Albans School, Edgware Business Association, St Albans Pool Group, Youth Group and the Shirley-Papanui Community Board. Since then, this group and Council staff have been working together and now have a concept design for feedback from the wider community.

The new facility will replace the existing transitional community centre at 122-126 Caledonian Road and 1049 Colombo Street.



View into central courtyard

Timeline

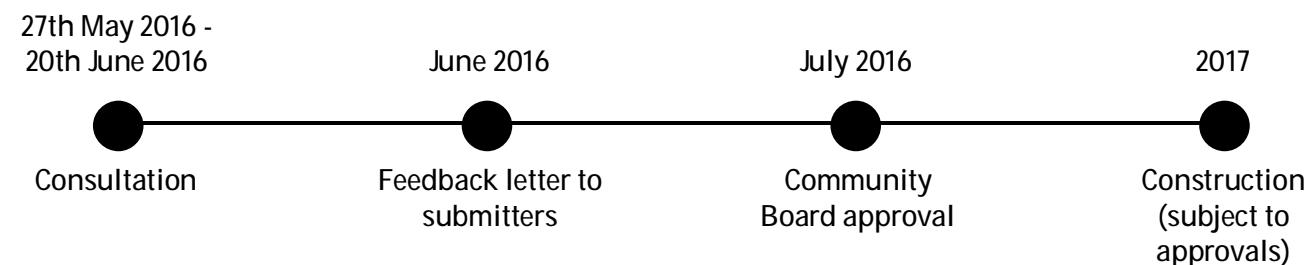

haveyoursay

www.ccc.govt.nz/haveyoursay

Ann Campbell
Senior Engagement Adviser
Christchurch City Council
PO Box 73013
Christchurch Mail Centre
Christchurch 8154
Phone (03) 941 8717
Email ann.campbell@ccc.govt.nz

If you wish to comment on the plan, please complete the enclosed freepost form and return by 5pm on Monday 20 June 2016.



haveyoursay

www.ccc.govt.nz/haveyoursay

Christchurch
City Council



have your say

May 2016

Proposed New St Albans Community Centre

Designed by your community for your community

Christchurch
City Council



View from Colombo Street

Background

An expansion to the St Albans Community Centre was originally planned for 2010 and was extensively consulted on. Following the 2011 earthquake the centre was severely damaged and required rebuilding. A transitional centre has been used since 2012, and intended to be operational for 2-5 years until a permanent solution was found.

Following feedback from the community, the Shirley-Papanui Community Board worked alongside staff and a community workshop was held on 9 September 2014. At this workshop, St Albans residents and community groups discussed 'A long term vision for community facilities in St Albans'. Out of that conversation came a commitment from the Community Board and community representatives to form a joint working group to ensure the project was submitted to the Long Term Plan. Through this submission, the funding was approved for the new St Albans Community Centre. (continued on back page)

haveyoursay

www.ccc.govt.nz/haveyoursay

Come and meet the working party and discuss the project.

Wednesday 8th of June - 11am to 1pm
Thursday 16th of June - 6pm to 8pm
St Albans Community Centre,
1049 Colombo Street

Please ensure that your comments reach us by 5pm on Monday 20 June 2016.

You can comment by:

- Returning the enclosed freepost form
- Visiting the Christchurch City Council's 'Have Your Say' website: www.ccc.govt.nz/haveyoursay

If you wish to discuss any aspect of this plan or process please contact:

Ann Campbell, Senior Engagement Adviser
Phone (03) 941 8717
Email ann.campbell@ccc.govt.nz

St Albans Community Centre - concept plan

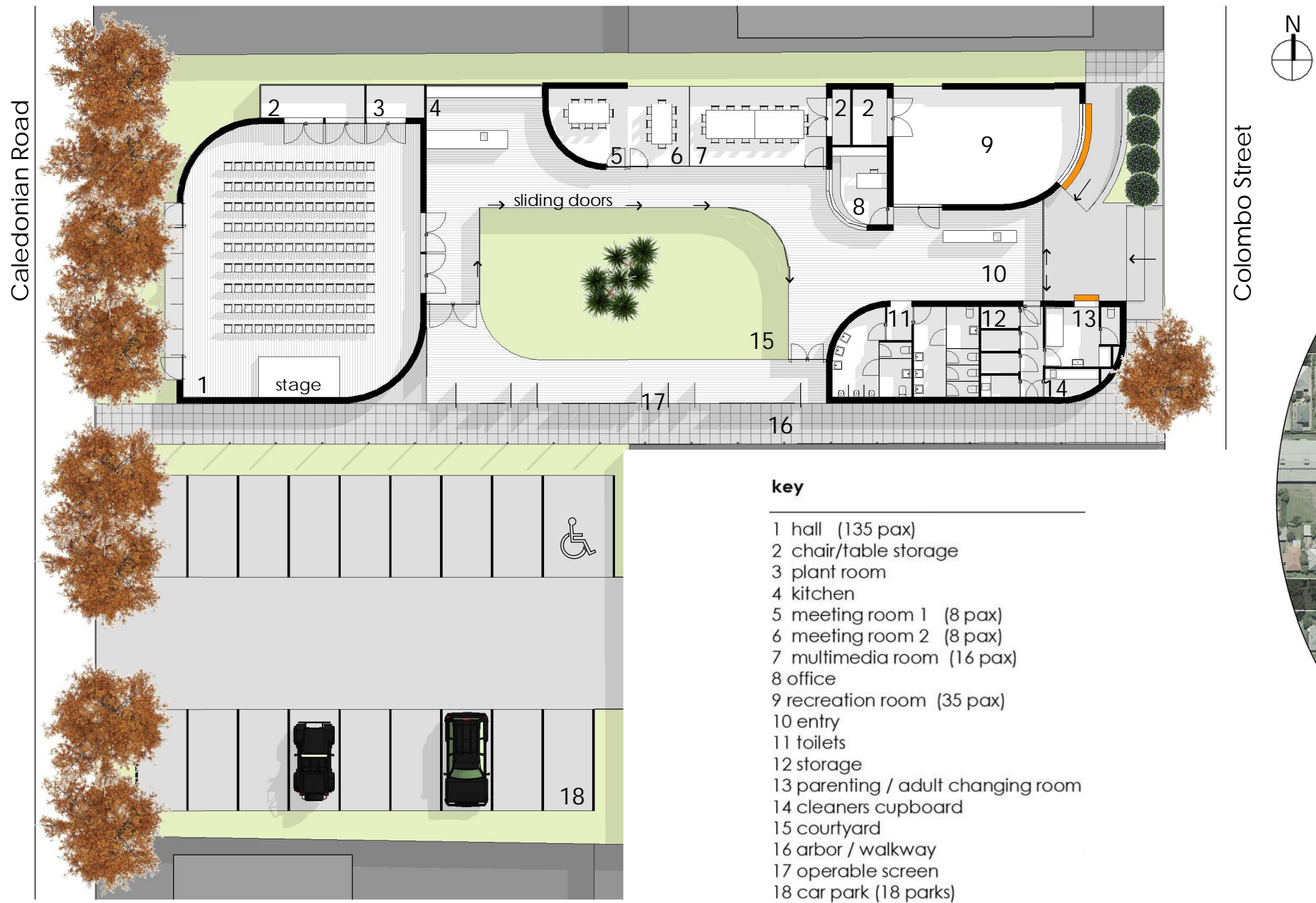

ST ALBANS COMMUNITY CENTRE - CONCEPT PLAN

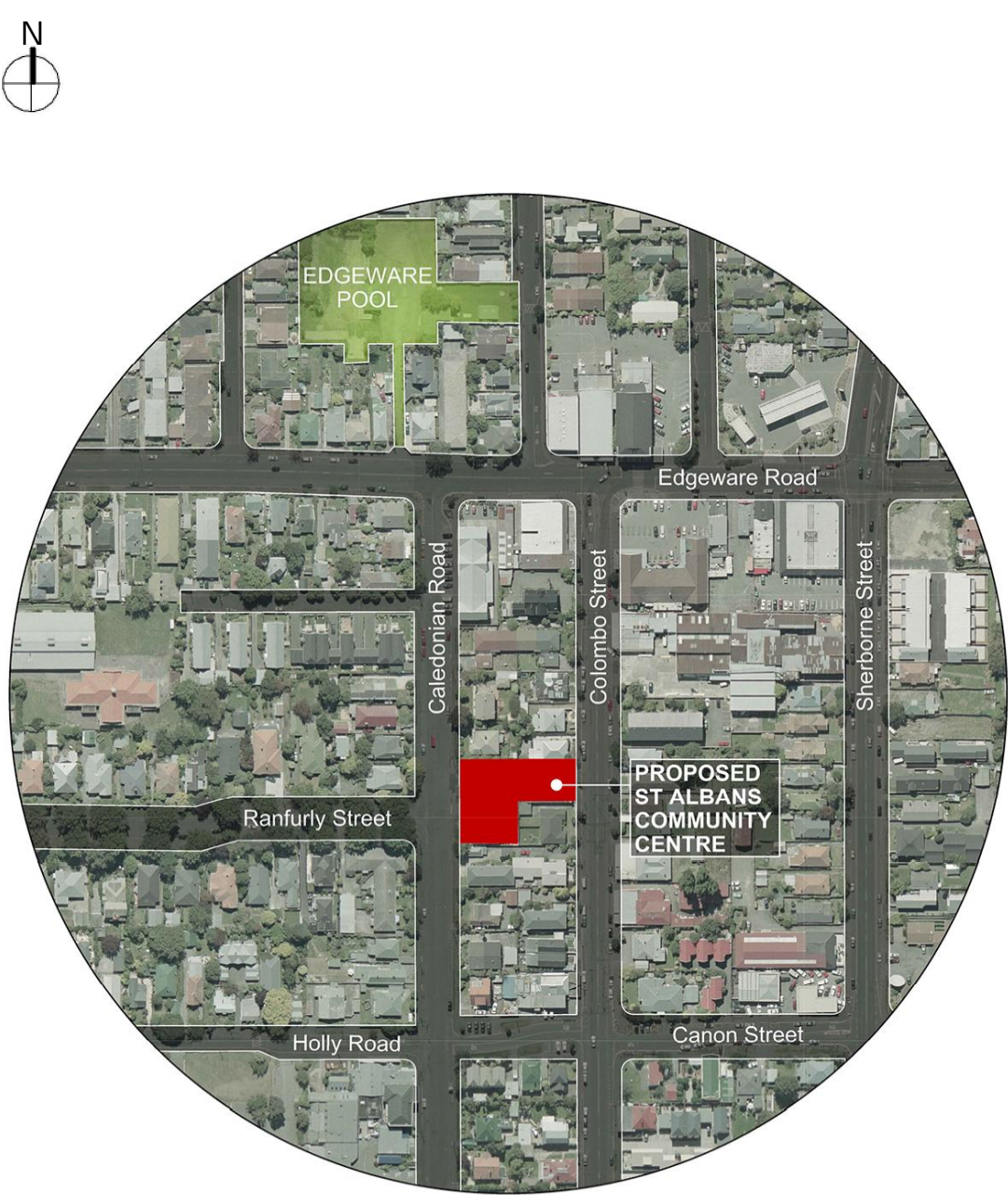

Building Features

- Considerations given to other buildings in the area.
- The facility is designed to be light, open and inviting, with the central core of the building able to open up and connect the internal environment with the external space.
- The rooms within the building contain a variety of meeting, activity, gathering and performance spaces that will cater from small to large activities in a flexible manner.
- The building is designed to be accessible for all persons, with broad spaces, wide doors and specialist facilities such as a parenting and adult change room.
- At the core of the building is a sheltered, landscaped courtyard, featuring at its centre the existing mature cabbage trees, linking the past to the future.
- The proposed St Albans Community Centre is intended to provide a happy and uplifting focus for the recreation and gathering of St Albans residents.